

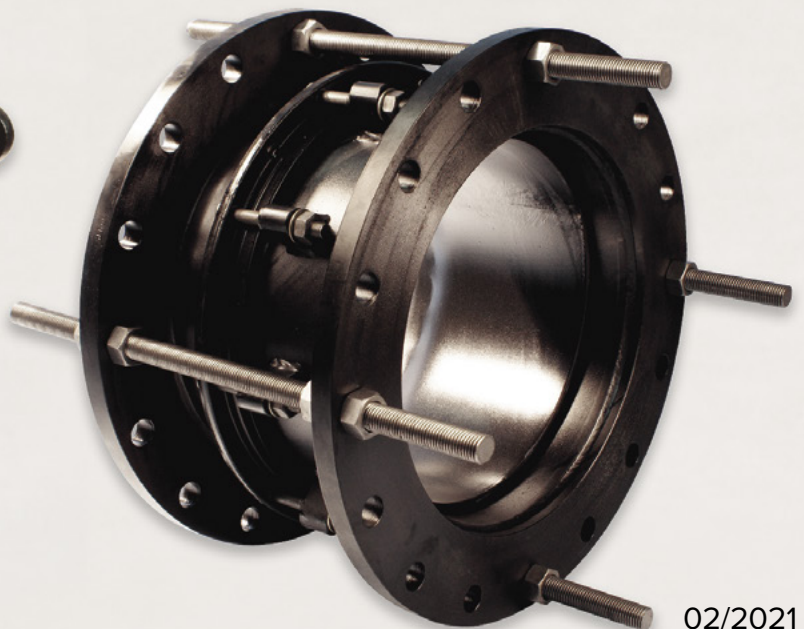

Ford Meter Box[®] Pipe Products for Metric Pipe

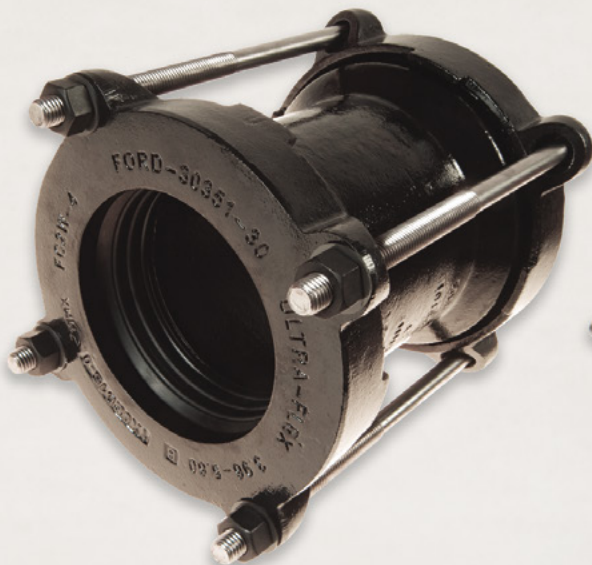
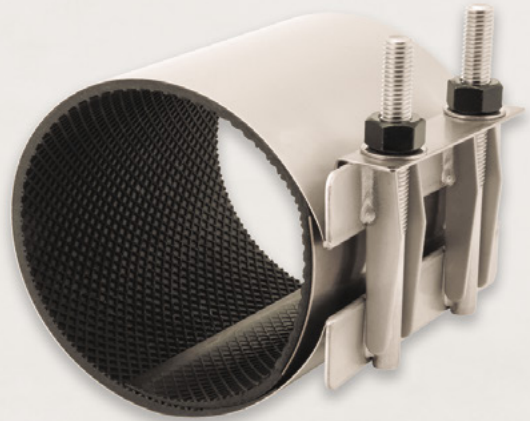
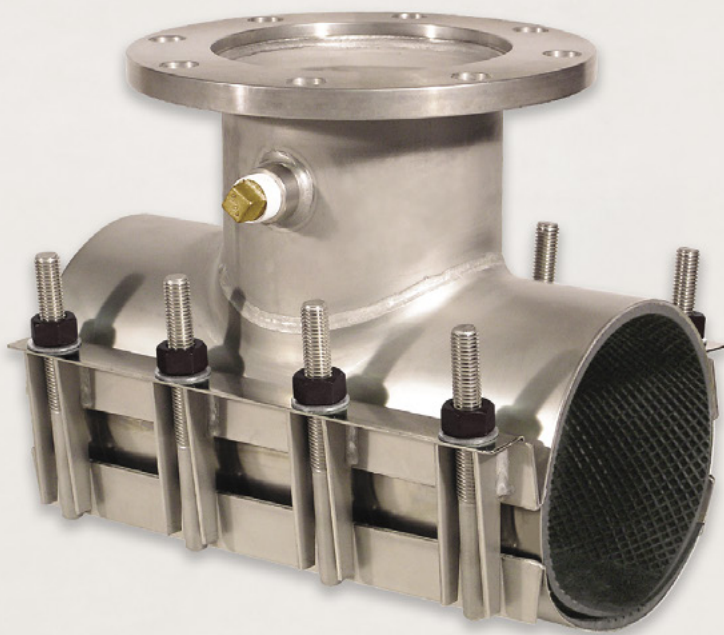

Contents

FAST Tapping Sleeve	
Specifications	4
How to Order	5
Installation	5
FTSS Tapping Sleeve	
Specifications	6
How to Order	7
Installation	7
FS1, FS2 and FS3 Repair Clamps	
Specifications	8
Typical Problems Solved with Repair Clamps	8
Passivation	8
Belleville Washers	8
How to Order	9
Installation	10
Snap Clamps	
Specifications	11
How to Order	11
Snap Clamps with Stainless Steel	
Lugs and Hardware	11
Installation	12
Typical Problems Solved with Snap Clamps	12
Wrap Clamps	
Specifications	13
How to Order	13
Installation	14
Typical Problems Solved with Wrap Clamps	14
Emergency Repair Clamp Kit	
Specifications	15
How to Order	15
Installation	16
Repair Clamp Kit Range Chart	17
FC2W Wide Range Coupling	
Specifications	18
How to Order	18
FC2W-L12 Long Sleeve Wide Range Couplings	19
Installation	19
Fabricated Steel Products	
Product Descriptions	20-21
Steel Couplings	22
How to Order Steel Couplings	22
Steel Transition Couplings	23
How to Order Steel Transition Couplings	23
Steel Reducing Couplings	24
How to Order Steel Reducing Couplings	24
Dismantling Joints	25
How to Order Dismantling Joints	25
Specialty Gaskets	
SO-EZ Gaskets	26
Metric Seal Gaskets	27
Ford Products	28
Frequently Asked Questions	29
Helpful Installation Tools	30-31
Warranty	Back Cover

The Ford Meter Box Company, Inc. is a family owned manufacturer headquartered in Wabash, Indiana, USA. Founded in 1898, Ford Meter Box has over a century of experience in making quality products for water distribution systems. The company operates two facilities in the USA, one in Wabash, Indiana and the other in Pell City, Alabama.

The Wabash, Indiana plant produces brass valves and fittings, water meter setting equipment, water meter testing equipment, and pipe drilling machines. The Pell City, Alabama plant manufactures tapping sleeves, repair clamps, water main pipe couplings, flanges adapters, fabricated steel products, and pipe joint restraint.

Since the beginning, The Ford Meter Box Company's main priority has been solving the problems of our customers by providing unique and innovative solutions. From the main to the meter, when you need quality waterworks products, responsive service and innovation, please think of Ford Meter Box.

Tapping Sleeves

Style FAST

Ford FAST Tapping Sleeves take the guesswork out of large pipe taps. A gridded gasket surrounds the pipe and not only cushions the pipe during the tap but also helps prevent pipe breaks. Each outlet flange is welded inside and out for additional strength.

The standard sleeve is constructed of ASTM A240 Type 304 (UNS S30400) stainless steel* to provide corrosion protection and ease of handling and installation. Sleeves are available in nominal pipe sizes 80mm through 300mm, with flanges from 80mm through 300mm. Detailed specifications and critical dimensions are outlined below.

*Also available with Type 316 stainless steel construction

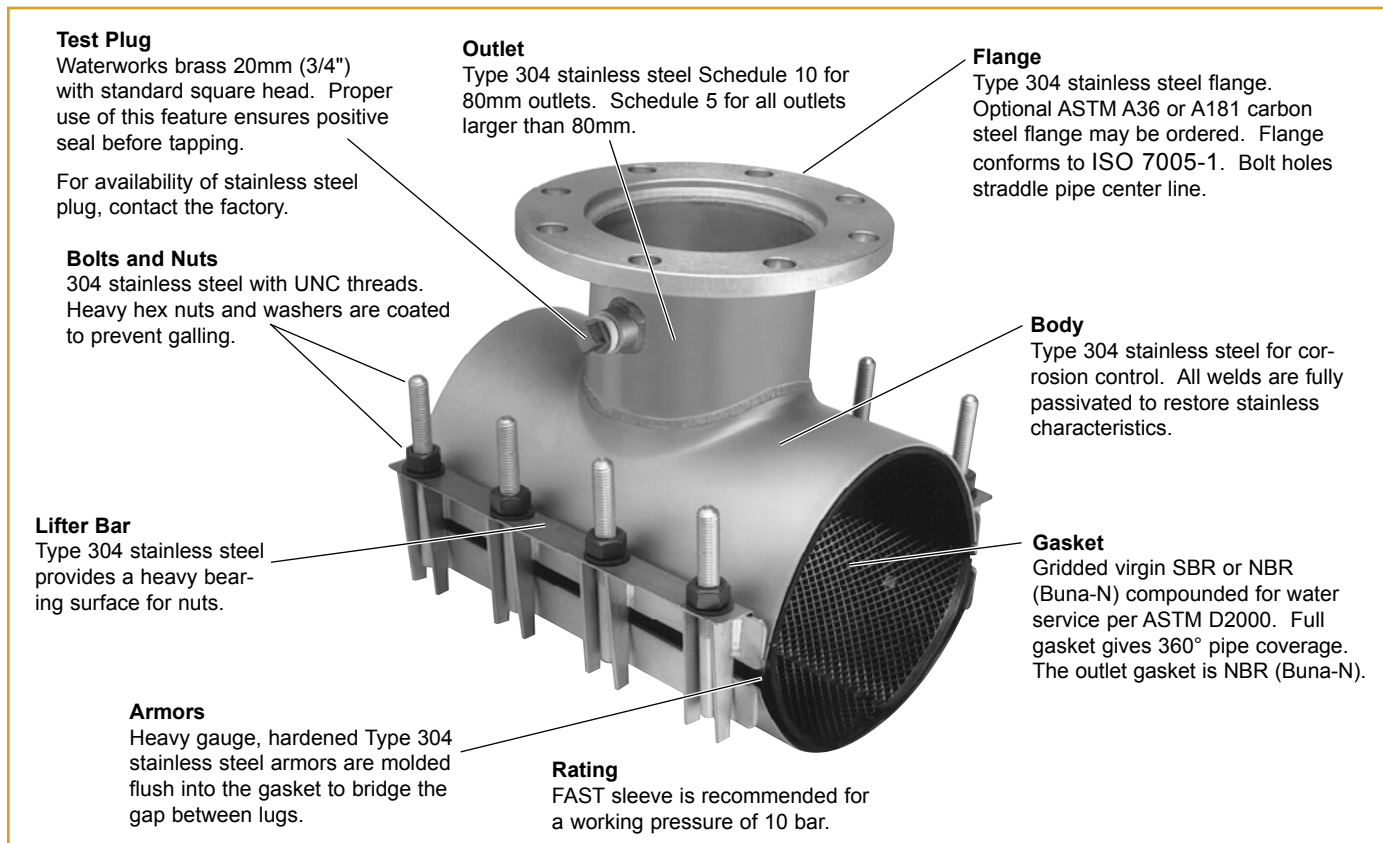

Alternate Flange Configuration

Alternate flange configurations are available. Contact the factory for details

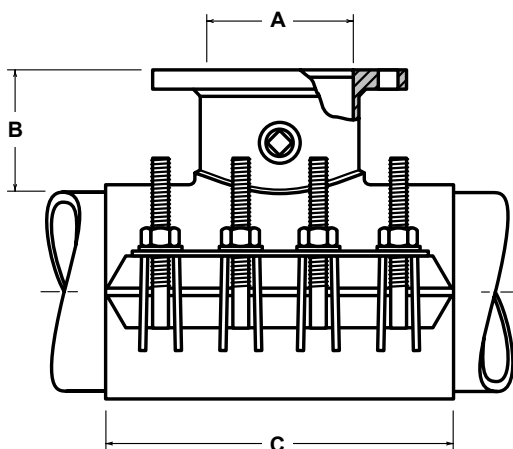
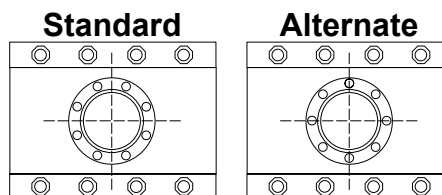

FAST Dimensions

NOM. PIPE SIZE	FLANGE SIZE	A	B	C	STUD SIZE	NO. OF STUDS	DESIGN STYLE
100mm through 300mm	80mm	90mm	115mm	350mm	16mm	8	2 pc.
	100mm	108mm	132mm	380mm	16mm	8	2 pc.
	150mm	162mm	140mm	380mm	16mm	8	2 pc.
	200mm	211mm	143mm	500mm	16mm	12	2 pc.
	250mm	260mm	156mm	500mm	20mm	12	2 pc.
	300mm	311mm	159mm	600mm	20mm	14	2 pc.

How to Order a FAST Style Tapping Sleeve

To Order: Select the catalog sleeve number for the desired range and complete the catalog number by adding the flange code. Example: The complete catalog number for a 200mm ductile iron pipe (pipe actual O.D. = 222mm) fits within 220mm - 232mm O.D. range with a 100mm PN16 stainless steel flange is FAST-232MM-100PN16. Please contact factory for prices and delivery on pipe O.D. sizes not covered by our standard range.

NOMINAL PIPE SIZE	PIPE O.D. RANGE (mm)	CATALOG NUMBERS	FLANGE SIZE	APPROX. WT. LBS. (kgs.)
80mm	89-101	FAST-101MM-x	80PN16	25 (11)
100mm	115-122	FAST-122MM-x	100PN16	25 (11)
150mm	168-178	FAST-178MM-x	100PN16	28 (13)
			150PN16	36 (16)
200mm	220-232	FAST-232MM-x	100PN16	32 (14)
			150PN16	40 (18)
			200PN16	58 (26)
250mm	274-286	FAST-286MM-x	100PN16	46 (21)
			150PN16	50 (23)
			200PN16	72 (33)
			250PN16	74 (34)
300mm	324-335	FAST-335MM-x	100PN16	49 (23)
			150PN16	53 (24)
			200PN16	72 (33)
			250PN16	77 (35)
			300PN16	110 (50)
	336-351	FAST-351MM-x	100PN16	51 (23)
			150PN16	55 (25)
			200PN16	74 (34)
			250PN16	79 (36)
			300PN16	112 (51)

Customized size, ranges and flanges are available. Please contact the factory for specialty requests.

How to Install a FAST Style Tapping Sleeve

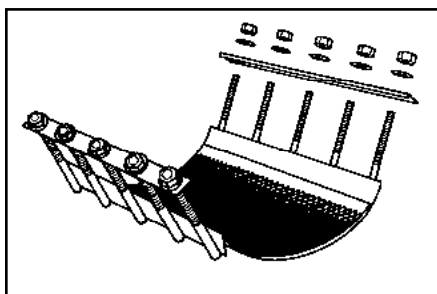

Disassemble the tapping sleeve and remove the nuts, washers and lifter bar from one side of the bolt section. Back the nuts to the extreme end of the bolts on the other side.

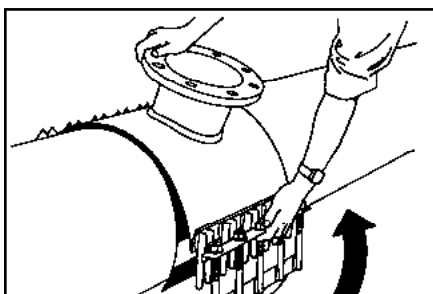

Lubricate the gaskets and pipe. Attach the lifter bar end of the bolt section to one side of the flange section. Do not tighten at this time. Make sure tapered ends of the gasket are not folded or rolled against the pipe.

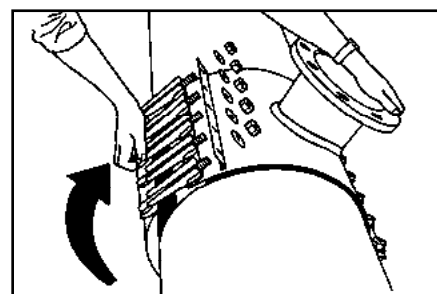

Pull the end of the bolt section with the nuts and lifter bar removed around the pipe, making sure no foreign material is trapped between the pipe and gasket. Position the bolts in the lugs on the flange section and install the lifter bar, washers and nuts. Hook the lifter bar over the lug/side bar assembly. Rotate the FAST to the desired position and tighten all the nuts in an alternating fashion until recommended torque is obtained.

Tapping Sleeves

Style FTSS

Removable Bolts and 360° Gasket

Ford FTSS Tapping Sleeves have a heavy gauge ASTM A240 Type 304 (UNS S30400) stainless steel* body with removable bolts. A gridded gasket surrounds the pipe, which cushions the pipe and helps prevent pipe breaks. All welds are chemically passivated to ensure maximum corrosion protection.

*Also available with Type 316 stainless steel construction

Test Plug

Waterworks brass 20mm (3/4") with standard square head. Proper use of this feature ensures positive seal before tapping.

For availability of stainless steel plug, contact the factory.

Bolts and Nuts

Type 304 stainless steel with UNC threads. Heavy hex nuts and washers coated to prevent galling.

Outlet

Type 304 stainless steel

Flange

Type 304 stainless steel flange. Optional ASTM A36 or A181 carbon steel flange may be ordered. Flange conforms to ISO 7005-1. Bolt holes straddle pipe center line.

Body

Type 304 stainless steel for corrosion control. All welds are fully passivated to restore stainless characteristics.

Gasket

Gridded virgin SBR or NBR (Buna-N) compounded for water service. ASTM D2000. Full gasket gives 360° pipe coverage. The outlet gasket is NBR (Buna-N).

Armors

Heavy gauge hardened Type 304 stainless steel armors are molded flush into the gasket to bridge the gap between lugs.

Rating:

FTSS sleeve is recommended for a working pressure of 10 bar.

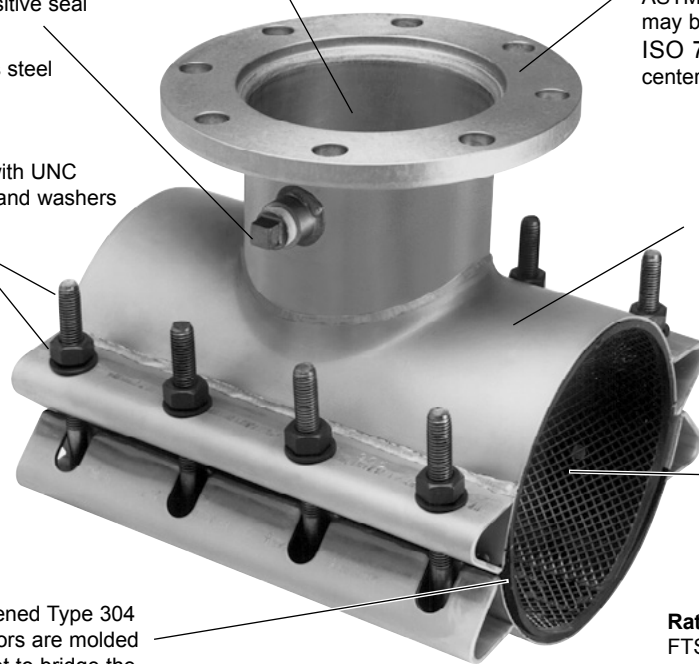

Alternate Flange Configuration

Alternate flange configurations are available. Contact the factory for details

Standard

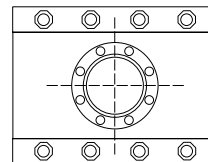

Alternate

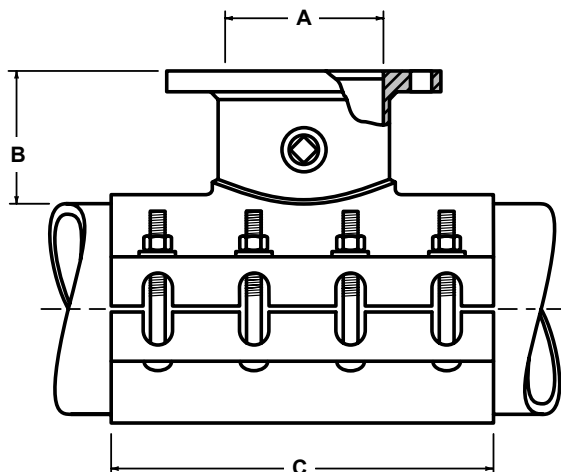
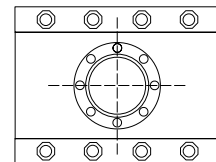

FTSS Dimensions

NOM. PIPE SIZE	FLANGED OUTLET SIZE	A	B	C	BOLT SIZE	NUMBER OF BOLTS
100mm through 300mm	100mm	108mm	132mm	380mm	16mm	8
	150mm	153mm	140mm	380mm	16mm	8
	200mm	162mm	143mm	500mm	16mm	12
	250mm	260mm	156mm	500mm	20mm	12
	300mm	311mm	159mm	600mm	20mm	14

How to Order an FTSS Style Tapping Sleeve

To Order: Select the catalog sleeve number for the desired range and complete the catalog number by adding the flange code.
Example: The complete catalog number for a 200mm ductile iron pipe (pipe actual O.D. = 222mm) fits within 220mm - 232mm O.D. range with a 100PN16 stainless steel flange is FTSS-232MM-100PN16. Please call for prices and delivery on pipe O.D. sizes not covered by our standard range.

NOMINAL PIPE SIZE	PIPE O.D. RANGE (mm)	CATALOG NUMBERS	FLANGE SIZE	APPROX. WT. LBS. (kgs.)
100mm	115-122	FTSS-122MM-x	100PN16	25 (11)
150mm	168-178	FTSS-178MM-x	100PN16	28 (13)
			150PN16	36 (16)
200mm	220-232	FTSS-232MM-x	100PN16	32 (14)
			150PN16	40 (18)
			200PN16	58 (26)
250mm	274-286	FTSS-286MM-x	100PN16	46 (21)
			150PN16	50 (23)
			200PN16	72 (33)
			250PN16	74 (34)
300mm	324-335	FTSS-335MM-x	100PN16	49 (23)
			150PN16	53 (24)
			200PN16	72 (33)
			250PN16	77 (35)
			300PN16	110 (50)
	336-351	FTSS-351MM-x	100PN16	51 (23)
			150PN16	55 (25)
			200PN16	74 (34)
			250PN16	79 (36)
			300PN16	112 (51)

Customized size, ranges and flanges are available. Please contact the factory for specialty requests.

How to Install an FTSS Style Tapping Sleeve

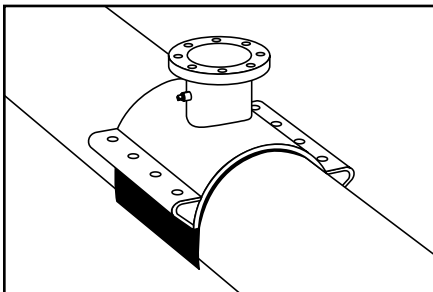

Disassemble the tapping sleeve.
 Lubricate the gasket and pipe and place the flange section of the tapping sleeve on top of the pipe.

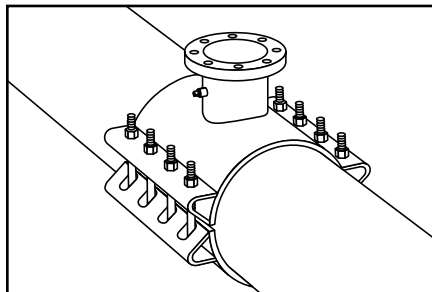

Loosely assemble the tapping sleeve onto the pipe. Make sure the tapered ends of the gasket are not folded or rolled against the pipe.

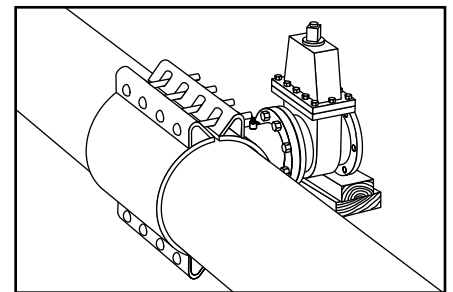

Rotate the tapping sleeve to the desired position and tighten the bolts according to the instructions supplied with the tapping sleeve.

Ford All Stainless Steel Repair Clamps

FS Style

The all stainless design is lightweight and easy to handle under adverse conditions associated with almost every main break. The fixed position of the studs provides uniform control and fewer parts to fall into the trench. The sliding lifter bar is retained on the studs by the heavy hex nuts and facilitates the installation by serving as a handle while installing the clamp. Bi-directionally tapered lugs allow the lifter bar to easily slide into locking position on the sidebar.

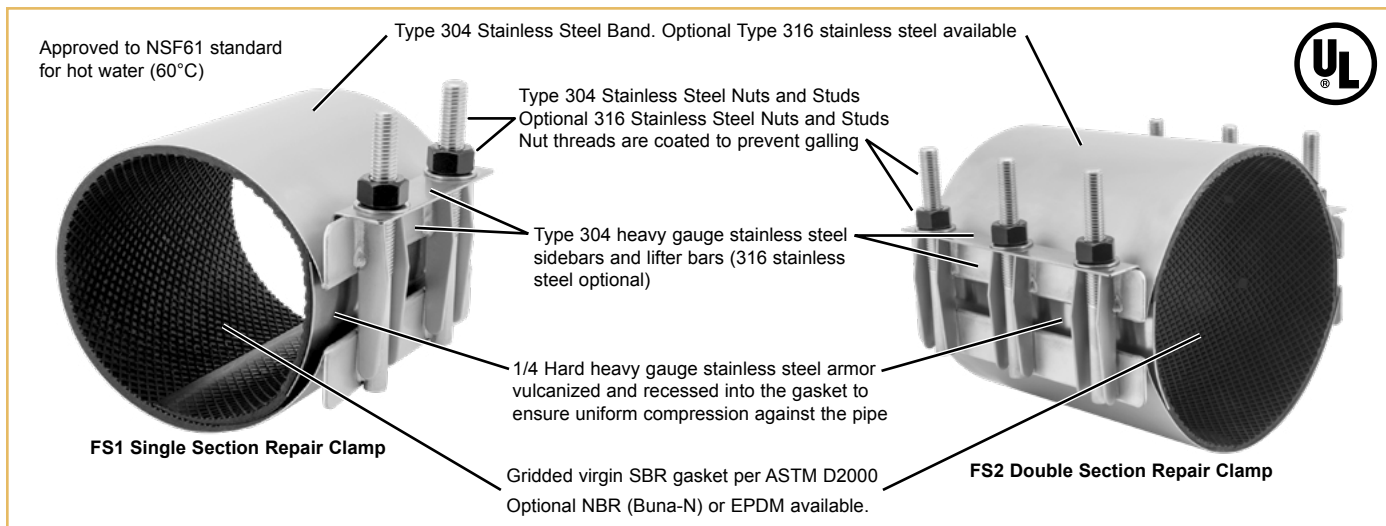

Ford FS style repair clamps provide dependable repair for holes or breaks in asbestos cement pipe, PVC pipe, steel pipe, cast iron pipe, and HDPE.

Typical Problems Solved with Repair Clamps

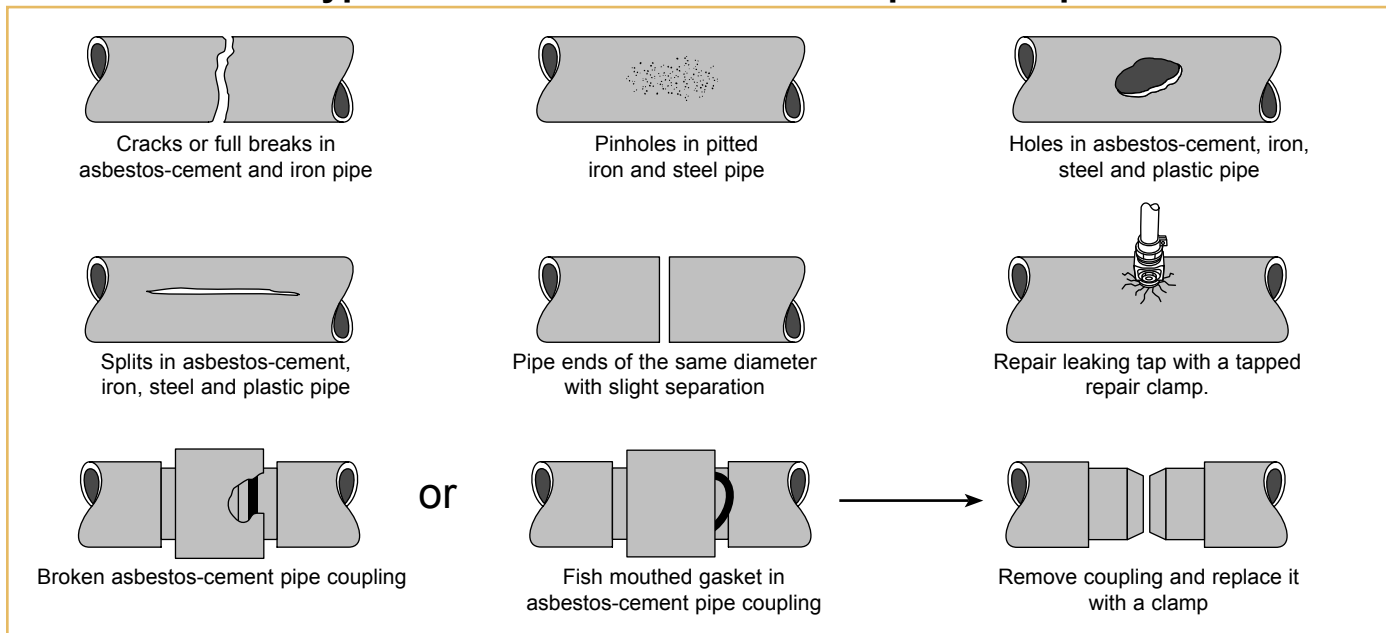

Passivated: All clamps are fully passivated by means of a chemical technique which restores the corrosion resistant characteristics of the stainless steel.

Belleville Washers for use on HDPE: Belleville washers, also referred to as spring washers, promote consistent force on the gasket as the pipe diameter expands and contracts. The Belleville washers are made of 17-7 PH stainless steel. Depending on the pipe size and recommended installation torque, Belleville washers are used singularly, or in a stack to allow for more expansion/contraction of the pipe.

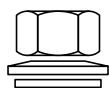

1 Washer Stack

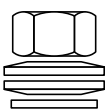

2 Washer Stack

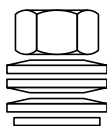

3 Washer Stack

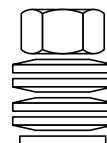

4 Washer Stack

How to Order an FS Style Repair Clamp

To Order: Select the catalog repair clamp number for the desired range and complete the catalog number by adding the desired repair clamp length. Example: The complete catalog number for a 200mm ductile iron pipe (pipe actual O.D. = 222mm) fits within the 215mm - 225mm O.D. range with a 250mm length is FS1-225MM-250. Please call for prices and delivery on pipe O.D. sizes not covered by our standard range.

FS1 Single Section Repair Clamps

DIAMETER RANGE	CATALOG NUMBER	PRESSURE RATING (BAR)*	BOLT SIZE	LENGTH AND APPROXIMATE SHIPPING WEIGHT (Kg.)				
				150mm	200mm	250mm	300mm	400mm
50-55	FS1-55MM-Length	24	1/2"	1.8	1.8	2.3	2.3	3.7
56-63	FS1-63MM-Length	24	1/2"	1.8	1.8	2.3	2.3	3.7
59-66	FS1-66MM-Length	24	1/2"	1.8	1.8	2.3	2.3	3.7
72-79	FS1-79MM-Length	24	1/2"	1.8	2.3	2.3	2.8	3.7
83-90	FS1-90MM-Length	20	1/2"	2.3	2.3	2.8	3.2	4.1
87-94	FS1-94MM-Length	20	1/2"	2.3	2.3	2.8	3.2	4.1
91-98	FS1-98MM-Length	20	1/2"	2.3	2.3	2.8	3.2	4.1
112-119	FS1-119MM-Length	20	1/2"	2.3	2.8	3.2	3.7	4.6
119-129	FS1-129MM-Length	20	5/8"	2.3	2.8	3.2	3.7	4.6
135-145	FS1-145MM-Length	12	5/8"	-	3.0	3.7	4.1	6.0
148-158	FS1-158MM-Length	12	5/8"	-	3.0	3.7	4.1	6.0
151-161	FS1-161MM-Length	12	5/8"	-	3.2	4.1	4.6	6.4
162-172	FS1-172MM-Length	12	5/8"	-	3.2	4.1	4.6	6.4
177-187	FS1-187MM-Length	12	5/8"	-	3.2	4.1	4.6	6.4
179-189	FS1-189MM-Length	12	5/8"	-	3.7	4.6	5.0	6.8
215-225	FS1-225MM-Length	12	5/8"	-	3.7	4.6	5.0	6.8
237-247	FS1-247MM-Length	10	5/8"	-	5.0	6.4	7.3	10.9
265-275	FS1-275MM-Length	10	5/8"	-	5.0	6.4	7.3	10.9
291-301	FS1-301MM-Length	6	5/8"	-	5.9	7.3	8.2	12.3
316-326	FS1-326MM-Length	6	5/8"	-	5.9	7.3	8.2	12.3
347-357	FS1-357MM-Length	6	5/8"	-	5.9	7.3	8.2	12.3
355-365	FS1-365MM-Length	6	5/8"	-	5.9	7.3	8.2	12.3

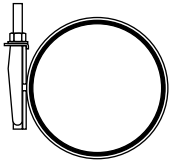

FS2 Double Section Repair Clamps

DIAMETER RANGE	CATALOG NUMBER	PRESSURE RATING (BAR)*	BOLT SIZE	LENGTH AND APPROXIMATE SHIPPING WEIGHT (Kg.)				
				200mm	250mm	300mm	400mm	500mm
165-185	FS2-185MM-Length	12	5/8"	5.7	5.8	7.1	12.5	15.1
208-228	FS2-228MM-Length	12	5/8"	5.9	7.3	9.6	13.7	17.3
234-254	FS2-254MM-Length	10	5/8"	-	7.3	9.6	13.7	17.3
257-277	FS2-277MM-Length	10	5/8"	-	8.2	10.5	14.6	18.7
290-310	FS2-310MM-Length	6	5/8"	-	8.2	10.5	14.6	18.7
313-333	FS2-333MM-Length	6	5/8"	-	8.7	11.4	15.5	20.0
345-365	FS2-365MM-Length	6	5/8"	-	8.7	11.4	15.5	20.0
354-374	FS2-374MM-Length	5	5/8"	-	9.1	12.3	16.4	21.4
374-394	FS2-394MM-Length	5	5/8"	-	9.5	12.5	16.8	22.4
394-414	FS2-414MM-Length	5	5/8"	-	9.9	13.5	17.2	23.4
414-434	FS2-434MM-Length	4.9	5/8"	-	10.3	14.5	17.6	24.4
434-454	FS2-454MM-Length	4.9	5/8"	-	10.7	15.5	18.0	25.4

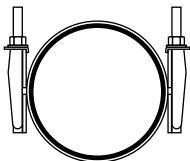

FS3 Triple Section Repair Clamps

DIAMETER RANGE	CATALOG NUMBER	PRESSURE RATING (BAR)*	BOLT SIZE	LENGTH AND APPROXIMATE SHIPPING WEIGHT (Kg.)				
				300mm	400mm	500mm	600mm	750mm
400-430	FS3-430MM-Length	4.9	5/8"	11	15	19	22	26
450-480	FS3-480MM-Length	4.5	5/8"	11.5	15.5	19.5	22.5	26.8
495-525	FS3-525MM-Length	4.1	5/8"	14	19	24	28	34
559-589	FS3-589MM-Length	3.6	5/8"	15	20	25	30	36
588-608	FS3-608MM-Length	3.5	5/8"	15.5	21	26	31	37
610-640	FS3-640MM-Length	3.3	5/8"	16	21.5	27	32.5	39

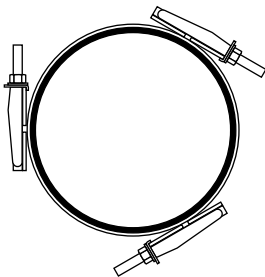

*The rated working pressures quoted above for water applications are based on worst case scenarios including circumferential cracks. When used to repair pipelines with less severe damage and dependant on the pipe surface, higher pressures may be achieved.

Please contact factory for sizes not listed in the tables above.

How to Install an FS Style Repair Clamp



Back off nuts to end of bolts, but **DO NOT** remove them. Lubricate the pipe and/or gasket (including both sides of tapered ends) with soapy water or any other acceptable lubricant to achieve maximum results. Separate clamp and wrap it around the pipe by holding the lifter bar and bolts above the pipe and sliding the receiver section under the pipe.

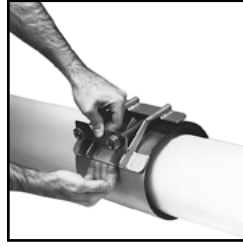

Bring the lifter bar and receiver section together at a convenient position on top of the pipe.



Slide the lifter bar up the receiver lugs and snap into place. Spin one of the nuts hand-tight.

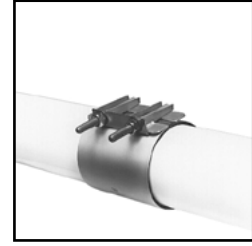

Tighten all nuts evenly with a recommended torque from table below. Match appropriate torque with size of bolts used in clamp.

For a proper installation Ford recommends that bolts be tightened to the following torque values:

BOLT SIZE	N.m	Ft. Lbs
1/2"	68 ~ 81	50 ~ 60
5/8"	95 ~ 108	70 ~ 80

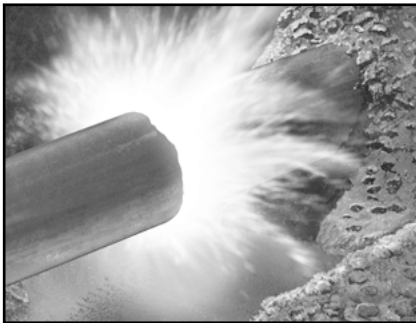

BEFORE

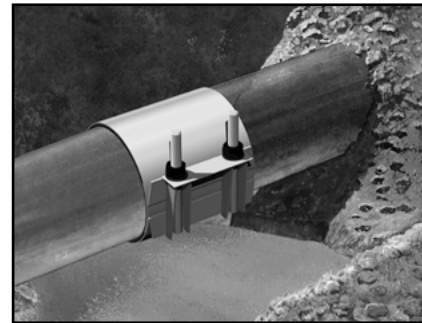

AFTER

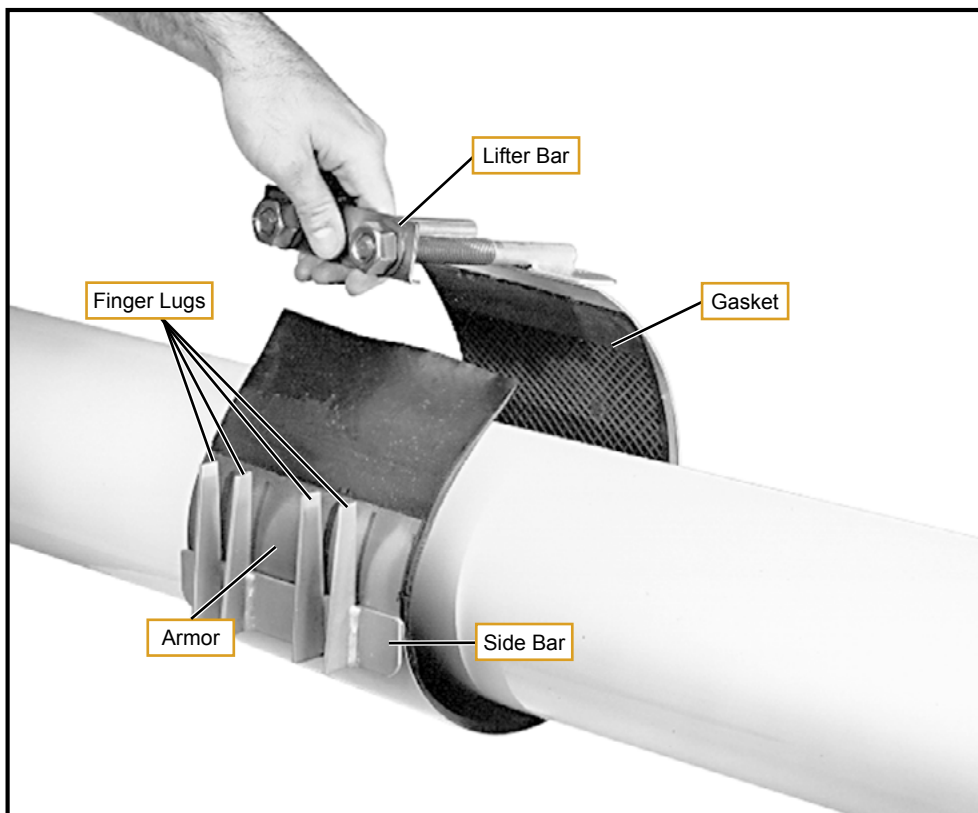

Ford Snap Clamps

FSC Style

Ford Snap Clamps offer an easy and economical way to repair pinholes and other small leaks on small diameter pipe. Ford Snap Clamps are ideal for repairs where a 360° gasket seal isn't required. A heavy gridded gasket design and "cushion lugs" make this repair clamp ideal for older pitted pipe that has worn thin.

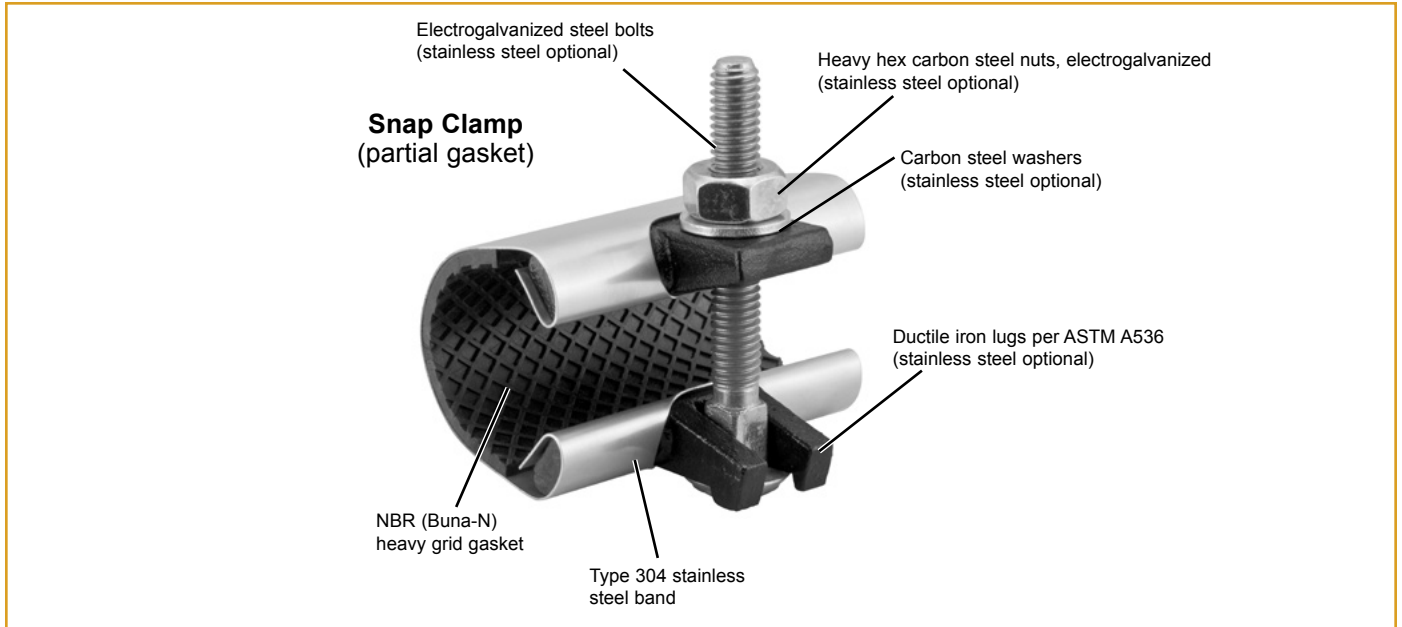

How to Order Ford Snap Clamps

To Order: Select the catalog repair clamp number for the desired size and length of clamp. Example: FSC-30MM-75. Please call for prices and delivery on sizes not listed in the catalog.

Snap Clamps with Ductile Iron Lugs

CLAMP RANGE	75MM LONG SNAP CLAMPS	
	CATALOG NUMBER	APPROX. WT. (KG)
15mm - 18mm	FSC-18MM-75	.29
19mm - 22mm	FSC-22MM-75	.29
23mm - 26mm	FSC-26MM-75	.30
26mm - 30mm	FSC-30MM-75	.30
31mm - 34mm	FSC-34MM-75	.30
33mm - 37mm	FSC-37MM-75	.31
42mm - 45mm	FSC-45MM-75	.32
48mm - 51mm	FSC-51MM-75	.33
50mm - 54mm	FSC-54MM-75	.33
60mm - 64mm	FSC-64MM-75	.49

CLAMP RANGE	150MM LONG SNAP CLAMPS	
	CATALOG NUMBER	APPROX. WT. (KG)
15mm - 18mm	FSC-18MM-150	.50
19mm - 22mm	FSC-22MM-150	.50
23mm - 26mm	FSC-26MM-150	.51
26mm - 30mm	FSC-30MM-150	.51
31mm - 34mm	FSC-34MM-150	.51
33mm - 37mm	FSC-37MM-150	.53
42mm - 45mm	FSC-45MM-150	.54
48mm - 51mm	FSC-51MM-150	.55
50mm - 54mm	FSC-54MM-150	.86
60mm - 64mm	FSC-64MM-150	.93

Snap Clamps with Stainless Steel Lugs and Hardware

CLAMP RANGE	75MM LONG SNAP CLAMPS	
	CATALOG NUMBER	APPROX. WT. (KG)
15mm - 18mm	FLSC-18MM-75	.29
19mm - 22mm	FLSC-22MM-75	.29
23mm - 26mm	FLSC-26MM-75	.30
26mm - 30mm	FLSC-30MM-75	.30
31mm - 34mm	FLSC-34MM-75	.30
33mm - 37mm	FLSC-37MM-75	.31
42mm - 45mm	FLSC-45MM-75	.32
48mm - 51mm	FLSC-51MM-75	.33
50mm - 54mm	FLSC-54MM-75	.33
60mm - 64mm	FLSC-64MM-75	.49

CLAMP RANGE	150MM LONG SNAP CLAMPS	
	CATALOG NUMBER	APPROX. WT. (KG)
15mm - 18mm	FLSC-18MM-150	.50
19mm - 22mm	FLSC-22MM-150	.50
23mm - 26mm	FLSC-26MM-150	.51
26mm - 30mm	FLSC-30MM-150	.51
31mm - 34mm	FLSC-34MM-150	.51
33mm - 37mm	FLSC-37MM-150	.53
42mm - 45mm	FLSC-45MM-150	.54
48mm - 51mm	FLSC-51MM-150	.55
50mm - 54mm	FLSC-54MM-150	.86
60mm - 64mm	FLSC-64MM-150	.93

How to Install Ford Snap Clamps

Style FSC

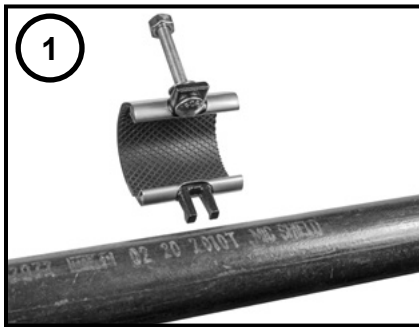

Step 1. Loosen the bolt.

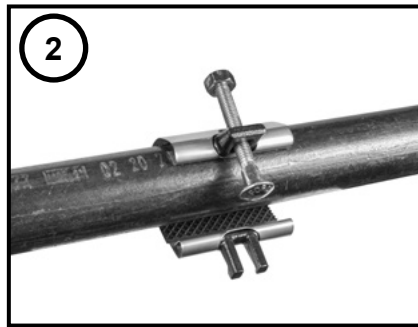

Step 4. Wrap the clamp over the leak on the pipe.

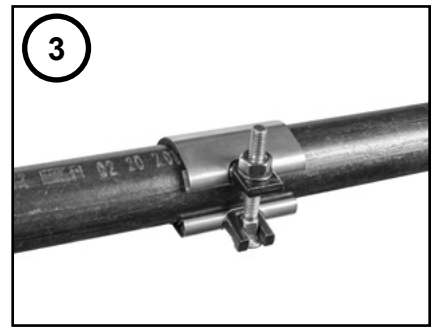

Step 3. Tighten the bolt to complete installation.

Typical Problems Solved with Snap Clamps

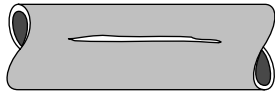

Splits in cast iron, copper and plastic pipe

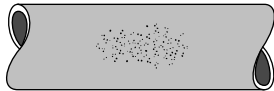

Pinholes in pitted cast iron and steel pipe

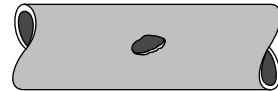

Holes in cast iron, steel and plastic pipe



Ford Wrap Clamps

FSC Style

Ford Wrap Clamps offer an easy and economical way to repair pinholes and other small leaks on small diameter pipe with the extra assurances of a 360° gasket seal. A heavy gridded gasket design and “cushion lugs” make this repair clamp ideal for older pitted pipe that has worn thin.

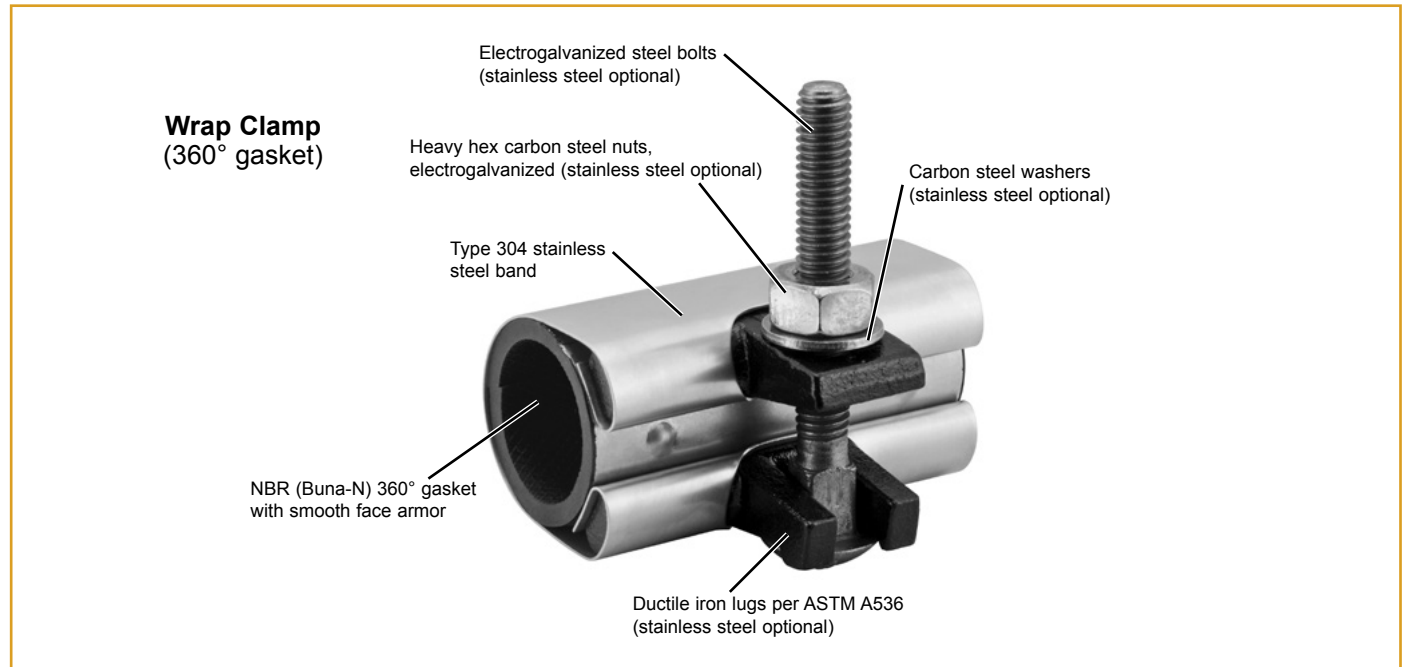

How to Order Ford Wrap Clamps

To Order: Select the catalog repair clamp number for the desired size and length of clamp. To order with the full Wrap Clamp gasket, add “R” to the catalog number. Example: FSC-32mm-75R. Please call for prices and delivery on sizes not listed in the catalog.

Wrap Clamps with Ductile Iron Lugs

CLAMP SIZE	75MM LONG WRAP CLAMPS	
	CATALOG NUMBER	APPROX. WT. (KG)
25mm	FSC-25MM-75R	.32
32mm	FSC-32MM-75R	.38
40mm	FSC-40MM-75R	.45
50mm	FSC-50MM-75R	.50
63mm	FSC-63MM-75R	.65

CLAMP SIZE	150MM LONG WRAP CLAMPS	
	CATALOG NUMBER	APPROX. WT. (KG)
25mm	FSC-25MM-150R	.65
32mm	FSC-32MM-150R	.75
40mm	FSC-40MM-150R	.82
50mm	FSC-50MM-150R	.90
63mm	FSC-63MM-150R	1.16

Wrap Clamps with Stainless Steel Lugs and Hardware

CLAMP SIZE	75MM LONG WRAP CLAMPS	
	CATALOG NUMBER	APPROX. WT. (KG)
25mm	FLSC-25MM-75R	.32
32mm	FLSC-32MM-75R	.38
40mm	FLSC-40MM-75R	.45
50mm	FLSC-50MM-75R	.50
63mm	FLSC-63MM-75R	.65

CLAMP SIZE	150MM LONG WRAP CLAMPS	
	CATALOG NUMBER	APPROX. WT. (KG)
25mm	FLSC-25MM-150R	.65
32mm	FLSC-32MM-150R	.75
40mm	FLSC-40MM-150R	.82
50mm	FLSC-50MM-150R	.90
63mm	FLSC-63MM-150R	1.16

How to Install Ford Wrap Clamps

Style FSC

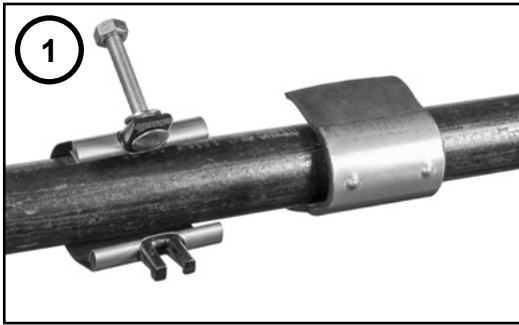

Step 1. Separate the clamp and remove the gasket assembly.

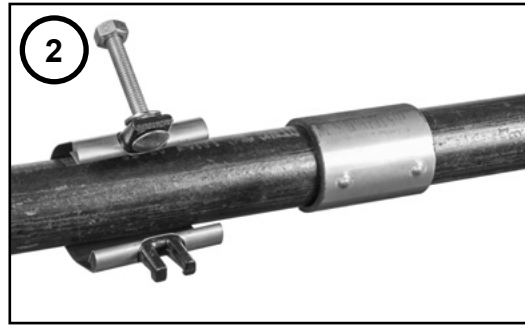

Step 2. Center the gasket assembly over the leak.



Step 3. Wrap the clamp over the gasket assembly.



Step 4. Tighten the bolt to complete installation.

Typical Problems Solved with Wrap Clamps

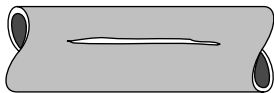

Splits in cast iron, copper and plastic pipe

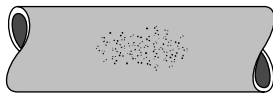

Pinholes in pitted cast iron and steel pipe

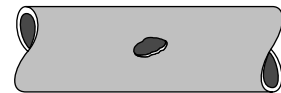

Holes in cast iron, steel and plastic pipe

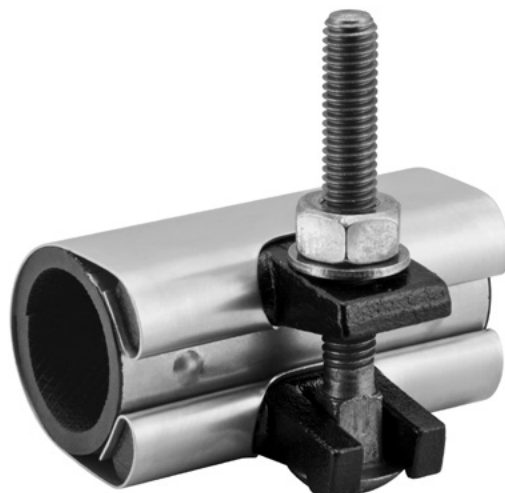

Ford Emergency Repair Clamp Kit

Style **FSERK**

When a water main breaks, precious water is lost until the properly sized repair clamp can be delivered. Unknown pipe size or type is no longer an issue with the Ford Emergency Repair Clamp Kit. Everything you need to repair most pipe sizes between 100mm – 900mm comes in Ford's lightweight, portable box! Save time, money and water by having the right clamp ready to go when an emergency strikes.



How to Order Ford Emergency Repair Clamp Kit

To order an Emergency Repair Clamp Kit or individual components, select the appropriate catalog number below. For increased pipe coverage, order the FSERK-L15-INTL for 375mm wide clamps, FSERK-L20-INTL for 500mm wide clamps, and FSERK-L24-INTL for 600mm wide clamps. Contact factory for other options like tapped outlet panels, 316 stainless steel or kits for HDPE.

CATALOG NUMBER	DESCRIPTION
FSERK-INTL	Complete Repair Clamp Kit
FS1-A-125-EPDM	Stainless Steel Band "A"
FS1-B-125-EPDM	Stainless Steel Band "B"
FS1-C-125-EPDM	Stainless Steel Band "C"
FS1-D-125-EPDM	Stainless Steel Band "D"
FS1-E-125-EPDM	Stainless Steel Band "E"
FN-58-SH-EP3	Stainless Steel Nut
FW-58-SS	Stainless Steel Washer
LIFTERBAR-55034-02	Stainless Steel Lifter Bar
FSERK-BOX	Plastic Carrier Box
FSERK-FOAM	Foam Insert for Box
OD-TAPE-MM	O.D. Tape Measure
FLP-10	Lube Packet

How to Install Emergency Repair Clamp Kit

Easy Installation



Step 1. Measure actual O.D. of damaged pipe with the provided O.D. tape measure.

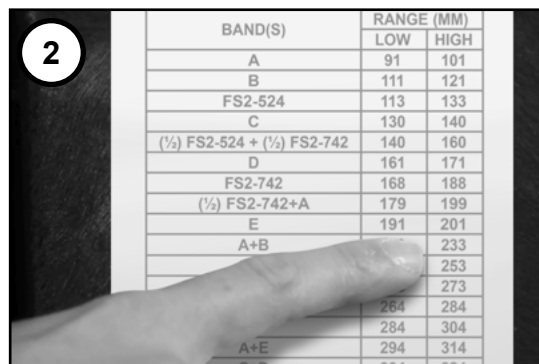

Step 2. Locate appropriate bands to fit pipe O.D. per the provided chart.

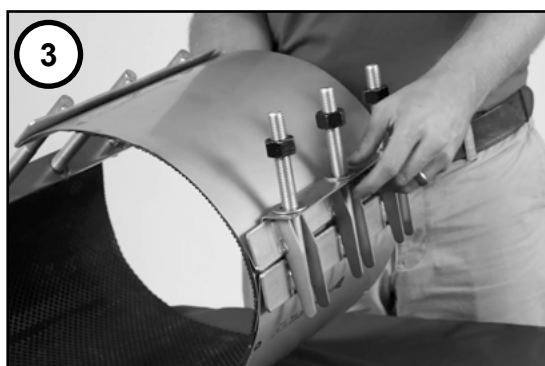

Step 3. Assemble the selected bands.

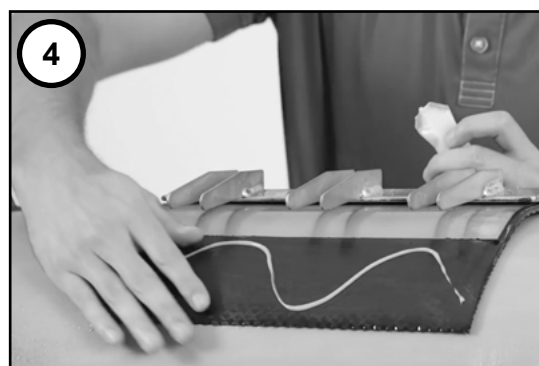

Step 4. Lubricate EPDM gaskets.



Step 5. Install on damaged pipe

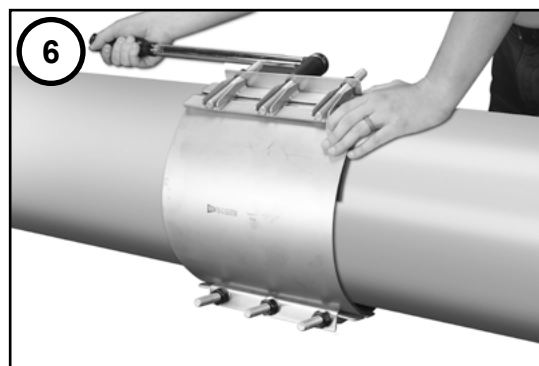

Step 6. Torque nuts per installation instructions.

Installation instructions and video are available online at www.fordmeterbox.com.

Ford Emergency Repair Clamp Kit

Style FSERK

Everything in One Complete Kit to Repair ANY 100mm - 900mm Size Pipe

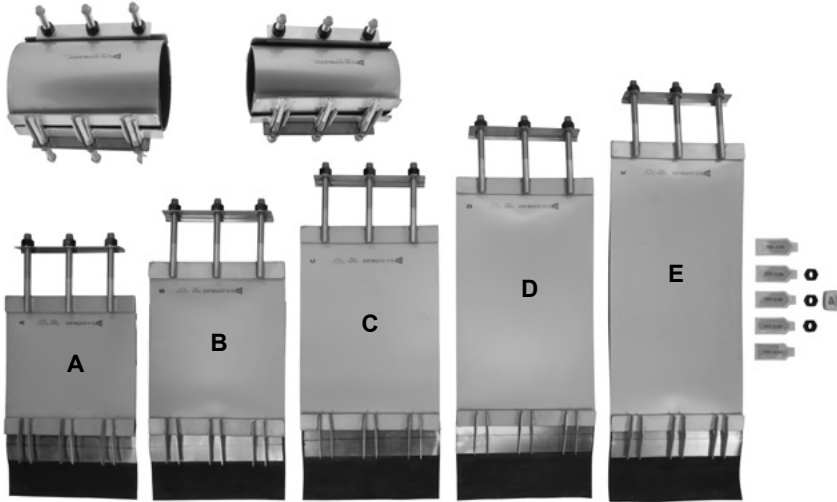

Eliminate time delay in locating the correct size repair clamp. When seconds count for critical water supply service, have the answer immediately available for repair of any pipe from 100mm to 900mm.

Eliminate unnecessary surprises in the field when discovering the size and type of pipe. Always have a repair clamp kit in stock that can successfully repair ANY 100mm – 900mm pipe.

Consolidate repair clamp stock. Always know that you have the answer to a pipe repair need for any size pipe from 100mm – 900mm available immediately on your shelf in one complete kit.

Easy installation in three simple steps:

- Step 1:** Measure O.D. with the provided O.D. tape measure
- Step 2:** Match the pipe O.D. with the pipe ranges in the chart provided with the kit to determine which band combination will fit O.D. (Note: most combinations do not require use of all bands provided in kit)
- Step 3:** Assemble recommended bands from chart and install.



BAND(S)	RANGE (MM)	
	LOW	HIGH
A	91	101
B	111	121
FS2-524	113	133
C	130	140
(½) FS2-524 + (½) FS2-742	140	160
D	161	171
FS2-742	168	188
(½) FS2-742+A	179	199
E	191	201
A+B	213	233
A+C	233	253
B+C	253	273
A+D	264	284
B+D	284	304
A+E	294	314
C+D	304	324
B+E	314	334
C+E	335	355
A+B+C	354	384
D+E	363	383
A+B+D	386	416
A+C+D	406	436
A+B+E	416	446
B+C+D	428	456
A+C+E	436	466
B+C+E	456	486
A+D+E	467	497
B+D+E	487	517
C+D+E	508	538
A+B+C+D	527	567
A+B+C+E	558	598
A+B+D+E	589	629
A+C+D+E	609	649
B+C+D+E	629	669
A+C+D+E+ (½) FS2-524	673	724
A+B+C+D+E	731	781
A+B+C+D+E+ (½) FS2-524	796	857
A+B+C+D+E+FS2-524	888	934

(½) = Requires only 1 section of the FS2 clamp

Replacement bands for replenishing your kit are available so you can always be ready for the next pipe repair emergency.

Ford Ultra-Flex Wide Range Couplings

Style FC2W

Ford Ultra-Flex Wide Range Couplings offer convenience, reliability, and inventory reduction. The Ultra-Flex can join virtually any pipes within a nominal size and is rated for 24 bar working pressure on 80mm - 300mm and 17 bar working pressure on 400mm. The stab-in design allows quicker installation and the standard fusion bonded epoxy coating provides corrosion protection. The standard NBR (Buna-N) gaskets are lubricated at the factory. No field lubrication is required. The unique gaskets seal on the pipe with fewer turns of the wrench. This allows the installer to use a standard deep-well socket, even when installing on pipes at the low end of the listed range.

Benefits:

- Stab-in installation. No disassembly required.
- Long standard sleeve.
- Unique gasket allows for quicker installation.
- 24 bar rated working pressure, sizes 80mm - 300mm
17 bar rated working pressure for 400mm

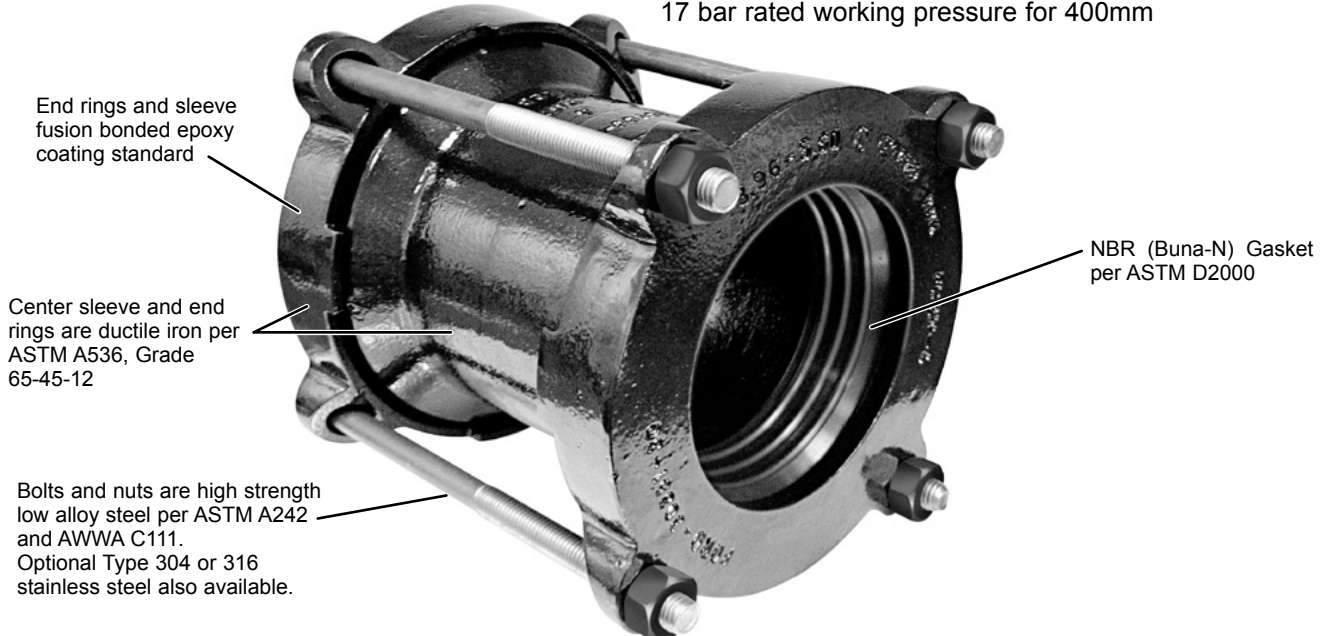

Caution: Restrain if necessary to provide thrust resistance. Flexible couplings do not prevent axial pipe movement.

How to Order FC2W

To Order: Select the catalog coupling number for the desired pipe O.D. range. Please call for prices and delivery on O.D. sizes not covered by the ranges listed below.

Style FC2W Wide Range Couplings

NOMINAL PIPE SIZE (MM)	PIPE OD RANGE*	CATALOG NUMBER	NUMBER OF BOLTS	BOLT DIAMETER	SLEEVE LENGTH	APPROX. WEIGHT KGS.
	MILLIMETERS					
80	63.5 - 109.0	FC2W-3	3	5/8"	178mm	12.3
100	100.5 - 142.2	FC2W-4	4	5/8"	178mm	15.9
150	158.2 - 193.0	FC2W-6	4	5/8"	178mm	20.0
200	213.3 - 247.6	FC2W-8	4	5/8"	178mm	23.6
250	273.0 - 307.8	FC2W-10	6	5/8"	229mm	31.5
300	323.8 - 365.25	FC2W-12	6	5/8"	229mm	44.0
400	406.4 - 452.1	FC2W-16	8	5/8"	251mm	61.2

* Pipes smaller than the published range may be joined using the FC2W coupling at a reduced pressure rating. Contact Ford Meter Box for details.

- Options:** **SH** Type 304 stainless steel nuts and bolts. Add "-SH" to the catalog number.
Q Type 316 stainless steel nuts and bolts. Add "-Q" to the catalog number.
EPDM EPDM gaskets. Add "-EPDM" to the catalog number.
BBN Blue fluorocarbon coating on HSLA nuts and bolts. Add "-BBN" to catalog number.



Rating: 24 bar
working water pressure

Ford Ultra-Flex Long Sleeve Wide Range Couplings

Style FC2W-L12

The long sleeve version of the Ford FC2W Ultra-Flex offers the same advantages as the standard FC2W with the added versatility of a 300mm long center sleeve.

Caution: Restrain if necessary to provide thrust resistance.
Flexible couplings do not prevent axial pipe movement.

Style FC2W-L12 Long Sleeve Wide Range Couplings

NOMINAL PIPE SIZE (MM)	PIPE OD RANGE*	CATALOG NUMBER	NUMBER OF BOLTS	BOLT DIAMETER	SLEEVE LENGTH	APPROX. WEIGHT KGS.
	MILLIMETERS					
80	63.5 - 109.0	FC2W-3-L12	3	5/8"	305mm	18.14
100	100.5 - 142.2	FC2W-4-L12	4	5/8"	305mm	20.42
150	158.2 - 193.0	FC2W-6-L12	4	5/8"	305mm	25.40
200	213.3 - 247.6	FC2W-8-L12	4	5/8"	305mm	30.84
250	273.0 - 307.8	FC2W-10-L12	6	5/8"	305mm	40.82
300	323.8 - 365.25	FC2W-12-L12	6	5/8"	305mm	49.44

* Pipes smaller than the published range may be joined using the FC2W coupling at a reduced pressure rating. Contact Ford Meter Box for details.

Options: SH Type 304 stainless steel nuts and bolts. Add "-SH" to the catalog number.
Q Type 316 stainless steel nuts and bolts. Add "-Q" to the catalog number.
EPDM EPDM gaskets. Add "-EPDM" to the catalog number.
BBN Blue fluorocarbon coating on HSLA nuts and bolts. Add "-BBN" to catalog number.
EC End Cap

How to Install FC2W

CAUTION

- Flexible couplings do not restrain axial movement of pipe.
- Flexible couplings are designed to float on pipe ends and are not designed to support the pipe. Block and shim as necessary.

INSTALLATION INSTRUCTIONS

- Measure outside diameter of each pipe end to be joined to ensure they are within the coupling range.
- Thoroughly clean each pipe end to a smooth, bare sealing surface.
- Stab each pipe end into the Ultra-Flex coupling. For ease of installation, it may be necessary to loosen the nuts when assembling on larger O.D. pipes. Disassembly of the coupling is not required. **NOTE: Do not lubricate the pipe OD or the gasket. If the coupling is disassembled, lubricate only the contoured lip of each end of the coupling sleeve prior to reassembly.**
- Center the coupling between the two pipe ends. The optimum pipe gap for the Ultra-Flex coupling is less than 25mm.
- Evenly tighten bolts in an alternating sequence, being certain that the end rings remain parallel to one another. Tighten bolts to the recommended torque shown in the table below. Use of a torque wrench is highly recommended and required to ensure proper torque.

Recommended Bolt Torque	
Nominal Coupling Size	Torque
80mm - 250mm	68 Nm
300mm - 400mm	102 Nm

- Restrain if necessary. Test and recheck bolt torque before backfilling. If a leak develops during testing, recheck bolt torque. Be advised that extreme torque can overstress coupling components.
- Extremely Important: Block and shim pipe ends and coupling as needed to ensure that the coupling remains at an equal distance from the pipe circumference.**

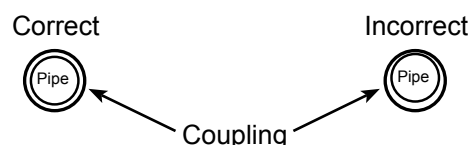

Fabricated Steel Products

The Ford Meter Box Company Pipe Products Division is able to custom-fabricate a variety of steel couplings and other products to meet your specific needs from diameters of 75mm to 1200mm and bigger. Each product is available with many options for coating, hardware and gaskets to meet any requirements and specifications. Contact factory for specific ordering information.

FC4 Steel Coupling

- Carbon steel center sleeve
- Carbon steel end rings
- Large variety of gasket, hardware and coating options
- For joining pipes of the same OD
- Sizes 355mm – 1500mm



The Ford FC4 Steel Coupling is an all steel coupling designed to connect various types of plain end pipe with the same OD and is available for pipe sizes up to 1500mm. Design and performance characteristics of fabricated steel couplings are specified in AWWA C219. The FC4 coupling is available in a variety of center sleeve lengths and thicknesses.

FC5 Steel Transition Coupling

- Steel center sleeve and end rings
- For joining pipes of different ODs
- Maximum transition between pipes is 25mm
- Sizes 355mm – 1500mm



The Ford FC5 Transition Coupling is an all steel product designed to connect plain end pipes with different ODs. When ordering, use the exact OD measurements of the two pipes to be joined. The numbering system chart on page 23 shows how to order an FC5 transition coupling for your specific needs. Generally, the maximum differential between two pipes to be joined may not exceed 25mm. For pipes with a measured differential of more than 25mm, refer to the Ford FC6 Transition Coupling.

FC6 Steel Reducing Coupling

- Steel center sleeve
- Ductile iron or steel end rings
- Connects pipe with diameter variations in excess of 25mm
- Sizes 50mm – 1500mm



The Ford FC6 Reducing Coupling is an all steel coupling designed to connect plain end pipes with an OD differential of more than 25mm. When ordering, use the exact OD measurements of the two pipes to be joined. Refer to the chart on page 24 which shows how to order the FC6 reducing coupling for your specific needs.

Fabricated Steel Products



Flanged Coupling Adapter

- Steel flange and center sleeve
- Ductile iron or steel end rings
- Options include anchor studs and harness assemblies
- Available with PN10 and PN16 flanges*
- For connecting plain end pipe to a flange
- Sizes 100mm – 1200mm
- Custom flanges are available. Contact the factory

*Contact factory for availability of flanges not listed.

The Ford FCA Flanged Coupling Adapter is used to connect plain end pipe to flanged fittings such as meters or valves. Thrust protection must be provided to prevent the pipe from blowing out of the adapter. Optional restrainers or anchor studs are offered as thrust protection. Ford FCAs are available with a wide range of AWWA, ISO, DIN and other custom flanges. Although normally furnished with flange size matching the nominal pipe size, reduced flange sizes are available.

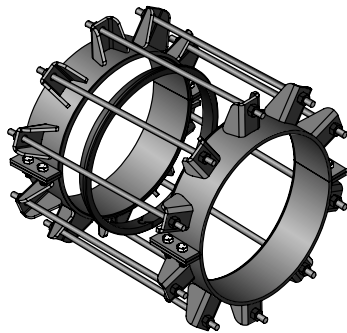

Bell Joint Leak Clamp

- For use on PVC or iron pipe
- To stop leaks at bell joints without disassembling
- Split steel rings
- Sizes 355mm to 1500mm

Ford Bell Joint Leak Clamps provide an easy and economical way of repairing leaking bell joints on PVC or iron pipe without recaulking or cutting out the joint, for easy installation. The clamp for cast iron pipe features an adjustable NBR (Buna-N) gasket, field adaptable to fit either the older style pit cast or ductile iron pipe. This versatile gasket contains a removable “keyed” insert that eliminates cutting or gluing to fit the ductile iron pipe.



Weld-on Tapping Sleeve

- Steel body
- Custom flanges are available. Contact the factory
- Furnished with 19mm test port
- For field welding to steel pipe
- Sizes 75mm – 305mm (contact factory for larger)

The Ford Weld-on Tapping Sleeve is designed for field welding to steel pipe. The saddle, sized to fit the pipe, has rounded corners to allow for a continuous weld. The welding surface is not painted. Standard flanges include PN10 and PN16. Other flanges are available. Contact the factory for details. All tapping sleeves are furnished with a 19mm test port.

Ford Steel Couplings

Style FC4 (355mm – 1500mm)

Bolts and Nuts - High strength low alloy steel ASTM A242 and AWWA C111

Optional: - Type 304 stainless steel
- Type 316 stainless steel
- Electro-galvanized steel
- Blue Fluorocarbon coating

Center Sleeve - ASTM A36
carbon Steel

Finish - Black shop coat
Optional: - Epoxy coating



Gaskets - SBR Rubber
Optional: - NBR (Buna-N)
- EPDM

End Rings - AISI 1018-1020
cold rolled or extruded carbon steel

Caution: Flexible couplings do not restrain axial pipe movement.
Unbalanced forces created by internal water pressure or external forces must be restrained.

How to order:

Our code system is used to designate the part number. Each code determines how the coupling will be manufactured. The coupling center sleeve thickness and length is generally determined by the pipe O.D. and the working pressure. Ford will manufacture FC4 couplings to your specifications using the material and dimensional parameters listed below.

The example shown below is an FC4-1255MM-B10R. This coupling is made to fit a pipe with an O.D. of 1255mm. It is manufactured using a 3/8" (9.5mm) by 10" (254mm) steel center sleeve and standard bolts, and is finished with a standard shop coat. For coupling length, coating and bolt options, select the proper catalog number to accommodate your pipe O.D. and substitute the desired option codes listed below.

FC4-1255MM-B 10 R

Product
Identification:
Fabricated
Steel
Coupling

Pipe O.D. (mm)

Center Sleeve
Thickness
A = 1/4" (6.5mm)
B = 3/8" (9.5mm)

Coupling Length
05 = 5" (127mm)
07 = 7" (178mm)
10 = 10" (254mm)
12 = 12" (305mm)
15 = 15" (381mm)
20 = 20" (508mm)
24 = 24" (610mm)

COATING, HARDWARE AND GASKET OPTIONS				
GASKET MATERIAL	COATING AND BOLT COMBINATIONS			
	Standard Alloy Bolts	304 Stainless Steel Bolts	316 Stainless Steel Bolts	Electro Galvanized Bolts
Standard Shop Coat				
SBR Rubber	R	X	Q	G
Buna-N Rubber	N	H	J	F
EPDM Rubber	S	M	V	W
Epoxy Coated				
SBR Rubber	E	Y	Z	K
Buna-N Rubber	C	P	T	O
EPDM Rubber	A	B	D	L

Note: See item listings in catalog section to assure that desired sizes and options are available

Ford Steel Transition Couplings

Style FC5 (355mm – 1500mm)

Bolts and Nuts - High strength low alloy steel per ASTM A242 and AWWA C111

Optional: - Type 304 stainless steel
- Type 316 stainless steel
- Electro-galvanized steel
- Blue Fluorocarbon coating

Center Sleeve - ASTM A36 carbon steel

Finish - Black shop coat
Optional: - Epoxy coating



Gaskets - SBR extruded or molded rubber
Optional: - NBR (Buna-N)
- EPDM

End Rings - AISI 1018-1020 cold rolled or extruded carbon steel

Caution: Flexible couplings do not restrain axial pipe movement.

Unbalanced forces created by internal water pressure or external forces must be properly restrained.

How to order:

Our code system is used to designate the part number. Each code determines how the coupling will be manufactured. Ford will manufacture FC5 couplings to your specifications using the material and dimensional parameters listed below. Generally, the maximum differential between two pipes to be joined may not exceed 25mm. For joining pipes with a greater OD differential, refer to Ford FC6 Steel Reducing Couplings.

The example listed below is an FC5-1255MM-1276MM-B10R. This coupling is made to couple a pipe with an OD of 1255mm to a pipe with an OD of 1276mm. It is manufactured using a 3/8" (9.5mm) by 10" (245mm) center sleeve with standard bolts, and is finished with standard shop coat. For other coupling length, coating and bolt options, select the proper catalog number to accommodate your pipe OD and substitute the desired code listed below.

FC5-1255MM-1276MM-B 15 R

Product Identification:
Fabricated
Steel
Transition
Coupling

Small End
Pipe O.D.
(mm)

Large End
Pipe O.D.
(mm)

Center Sleeve
Thickness
A = 1/4" (6.5mm)
B = 3/8" (9.5mm)

Coupling Length
05 = 5" (127mm)
07 = 7" (178mm)
10 = 10" (254mm)
12 = 12" (305mm)
15 = 15" (381mm)
20 = 20" (508mm)
24 = 24" (610mm)

COATING, HARDWARE AND GASKET OPTIONS				
GASKET MATERIAL	COATING AND BOLT COMBINATIONS			
	Standard Alloy Bolts	304 Stainless Steel Bolts	316 Stainless Steel Bolts	Electro Galvanized Bolts
Standard Shop Coat				
SBR Rubber	R	X	Q	G
Buna-N Rubber	N	H	J	F
EPDM Rubber	S	M	V	W
Epoxy Coated				
SBR Rubber	E	Y	Z	K
Buna-N Rubber	C	P	T	O
EPDM Rubber	A	B	D	L
Note: See item listings in catalog section to assure that desired sizes and options are available				

Ford Steel Reducing Couplings

Style FC6

Bolts and Nuts - High strength low alloy steel per ASTM A242 and AWWA C111

- Optional:
- Type 304 stainless steel
 - Type 316 stainless steel
 - Electro-galvanized steel
 - Blue Fluorocarbon coating

Gasket - SBR Rubber
Optional:

- NBR (Buna-N)
- EPDM

End Rings - 100mm - 300mm per ASTM A536 ductile iron; 355mm - 1500mm AISI carbon steel (1018-1020) or ASTM A536 ductile iron

Body Sleeve - ASTM A36 carbon steel

Finish - Black shop coat
Optional:

- Epoxy coating

Rated Working Water Pressure - 10 bar working water pressure for a coupling with a reduction of two nominal pipe sizes or less.

For information about high pressure applications or reductions of more than two nominal pipe sizes, please contact your Ford Meter Box Customer Service Representative.

Caution: Reducing couplings do not restrain axial pipe movement. Unbalanced forces created by internal water pressure or external forces must be properly restrained.

How to order:

Our code system is used to designate the part number. Each code determines how the coupling will be manufactured. Ford will manufacture FC6 couplings to your specifications using the material and dimensional parameters listed below.

The example shown below is an FC6-1152MM-1255MM-R. This coupling is made to couple a pipe with an OD 1152mm to a pipe with an OD of 1255mm. It is manufactured with standard bolts, an SBR gasket and is finished with a standard shop coat. For other coupling gaskets, coating and bolt options, select the proper catalog number to accommodate our pipe and substitute the desired codes listed below.

FC6-1255MM-1152MM-R

Product Identification:
Fabricated Steel Reducing Coupling

Large End Pipe O.D.

Small End Pipe O.D.

COATING, HARDWARE AND GASKET OPTIONS				
COATING AND BOLT COMBINATIONS				
GASKET MATERIAL	Standard Alloy Bolts	304 Stainless Steel Bolts	316 Stainless Steel Bolts	Electro Galvanized Bolts
Standard Shop Coat				
SBR Rubber	R	X	Q	G
Buna-N Rubber	N	H	J	F
EPDM Rubber	S	M	V	W
Epoxy Coated				
SBR Rubber	E	Y	Z	K
Buna-N Rubber	C	P	T	O
EPDM Rubber	A	B	D	L

Note: See item listings in catalog section to assure that desired sizes and options are available

Ford Dismantling Joint

Style FDJ

Ford Dismantling Joints are flanged joint fittings that provide longitudinal adjustment in a flanged piping system. This allows for flexibility during design and installation as well as easy accessibility for maintenance.

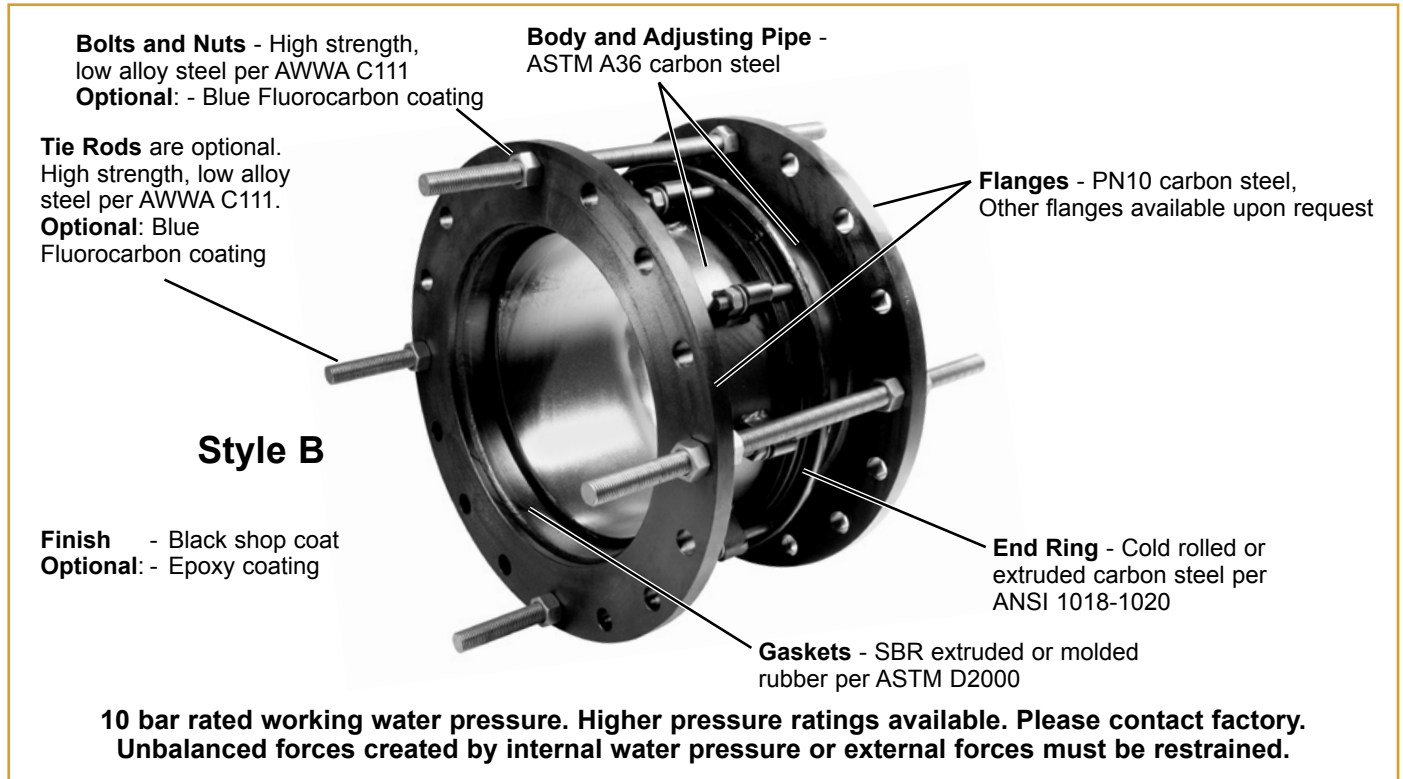

How to Order Ford Dismantling Joints

How to order:

Select the catalog number that corresponds to the desired size. For flanges other than PN10, contact factory.

NOMINAL SIZE	CATALOG NUMBER	STYLE	NOMINAL LENGTH (MM)	MINIMUM LENGTH (MM)	MAXIMUM LENGTH (MM)	APPROX. WEIGHT KGS.
80mm	FDJ-80MM-PN10R	B	219.1	203.2	241.3	13.71
100mm	FDJ-100MM-PN10R	B	320.7	279.4	362.0	16.33
150mm	FDJ-150MM-PN10R	B	336.6	304.8	381.0	23.59
200mm	FDJ-200MM-PN10R	B	393.7	355.6	438.2	34.02
250mm	FDJ-250MM-PN10R	B	403.2	358.8	447.7	40.82
300mm	FDJ-300MM-PN10R	B	403.2	365.3	441.3	57.61
350mm	FDJ-350MM-PN10R	B	387.4	349.3	425.5	127.01
400mm	FDJ-400MM-PN10R	B	393.7	355.6	421.8	133.81
450mm	FDJ-450MM-PN10R	B	406.4	365.1	441.3	138.35
500mm	FDJ-500MM-PN10R	B	406.4	365.1	441.3	292.57
600mm	FDJ-600MM-PN10R	B	406.4	365.1	441.3	428.65

FDJ-150MM-PN10 R

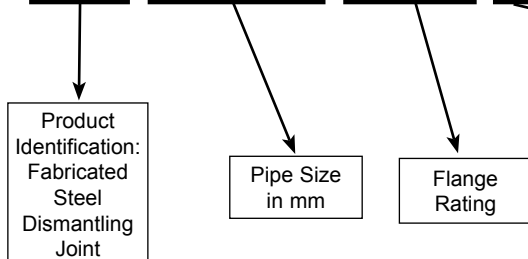

COATING, HARDWARE AND GASKET OPTIONS				
GASKET MATERIAL	COATING AND BOLT COMBINATIONS			
	Standard Alloy Bolts	304 Stainless Steel Bolts	316 Stainless Steel Bolts	Electro Galvanized Bolts
Standard Shop Coat				
SBR Rubber	R	X	Q	G
Buna-N Rubber	N	H	J	F
EPDM Rubber	S	M	V	W
Epoxy Coated				
SBR Rubber	E	Y	Z	K
Buna-N Rubber	C	P	T	O
EPDM Rubber	A	B	D	L

For 316 stainless steel hardware and epoxy coating, add "Z" to the part number. Example: FDJ-80MM-PN10Z.

Specialty Gaskets

SO-EZ Gasket

The Ford SO-EZ Gasket is for use on 3"-12" (75mm-300mm) to connect ISO 2531 ductile iron pipe to a mechanical joint fitting. The gasket snaps directly to a mechanical joint gland or restraint gland for stab-fit pipe insertion.

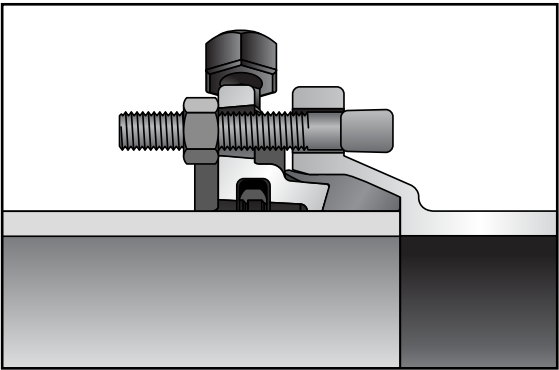

SO-EZ Gaskets 3" - 12" (75mm - 300mm)

- Pipe:** IPS PVC, C900 PVC, C909, HDPE, SDR-35*, Ductile Iron, and ISO Ductile Iron
Material: SBR rubber per ASTM D2000
Option: "-N" for NBR (Buna-N) in sizes 4" - 12" (75mm - 300mm)

PART NUMBER	DESCRIPTION	PIPE OD (INCHES)		PIPE OD (MM)		NBR* MIN
		MIN	MAX	MIN	MAX	
SO-EZ-3	3" SO-EZ MJ Gasket	3.50	3.96	89	101	NA
SO-EZ-4	4" SO-EZ MJ Gasket	4.50	4.80	115	122	4.21
SO-EZ-5	6" SO-EZ MJ Gasket	6.63	6.90	168	175	6.28
SO-EZ-8	8" SO-EZ MJ Gasket	8.63	9.05	219	230	8.40
SO-EZ-10	10" SO-EZ MJ Gasket	10.75	11.10	273	282	10.50
SO-EZ-12	12" SO-EZ MJ Gasket	12.75	13.20	324	335	12.50

* Requires "-N" suffix designating NBR (Buna-N) material.

Note: Ford recommends the use of a properly sized insert stiffener when used on HDPE.

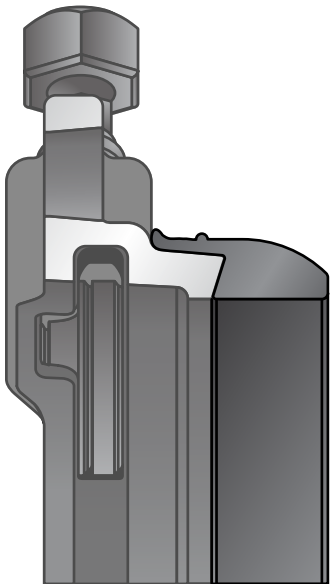

Specialty Gaskets

Metric-Seal

The Ford Metric-Seal gasket, available in sizes 14"-24" (350mm-600mm), is the only gasket for connecting ISO 2531 ductile iron pipe to AWWA mechanical joint valves and fittings. The gasket snaps directly to the mechanical joint gland for stab-fit pipe insertion and maintains the alignment of the gland/gasket assembly with the pipe.

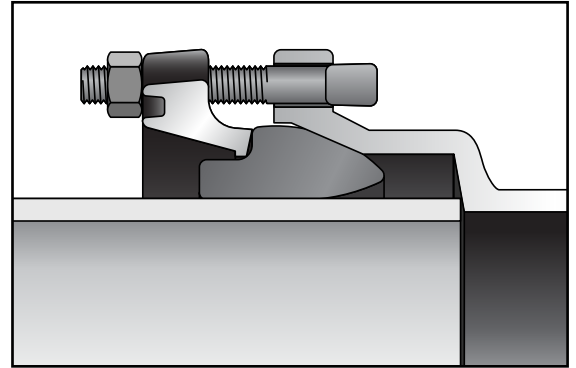

Metric-Seal Gaskets 14" - 24" (350mm - 600mm)

Pipe: ISO 2531 Ductile Iron Pipe

Material: SBR rubber per ASTM D2000

Option: "-N" for NBR (Buna-N)

PART NUMBER	DESCRIPTION	PIPE OD
METRIC-SEAL-1488	14" METRIC SEAL MJ Gasket - 14.88"	378mm
METRIC-SEAL-1689	16" METRIC SEAL MJ Gasket - 16.89"	429mm
METRIC-SEAL-1980	18" METRIC SEAL MJ Gasket - 18.90"	480mm
METRIC-SEAL-2094	20" METRIC SEAL MJ Gasket - 20.94"	532mm
METRIC-SEAL-2500	24" METRIC SEAL MJ Gasket - 25.00"	635mm

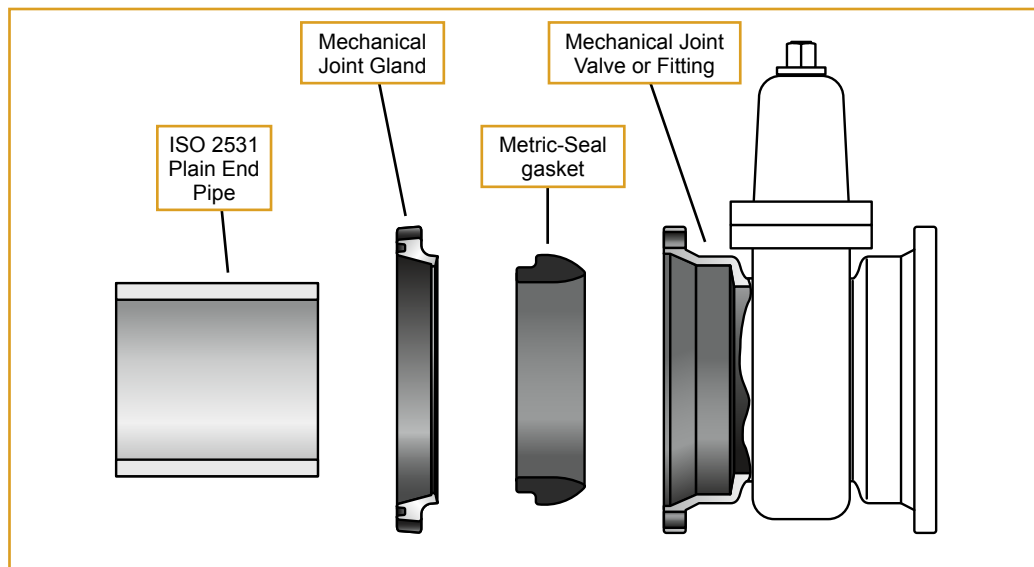
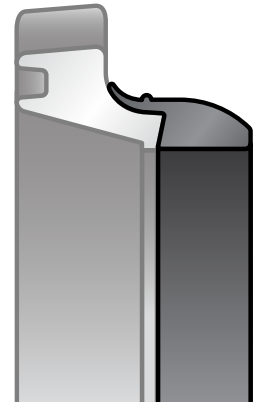

Ford Products

In addition to pipeline products, Ford Meter Box also makes products to solve any need in service connection and metering applications. The products listed below are also crucial components in potable water distribution systems. Since 1898, Ford Meter Box has specialized in offering tailored solutions to utilities for reducing NRW and ensuring that the water distribution system is consistent, efficient and leak-free, *from the main to the meter*.



Corporation Stops
Catalog Section A



Drilling Machines
Catalog Section AB

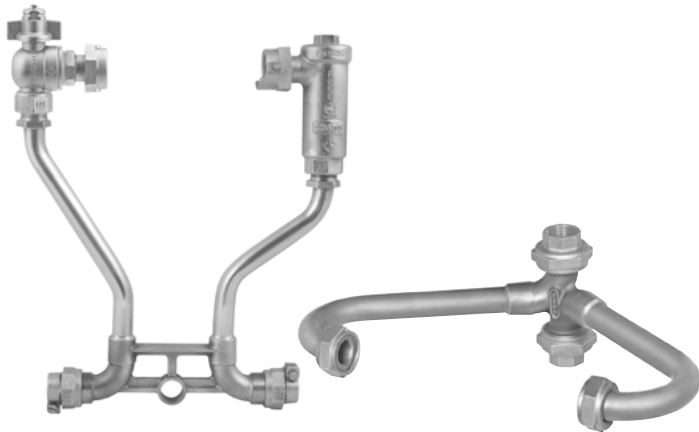

**Coppersettors. Linesettors,
Resettors and Inside Setters**
Catalog Sections B and F



**Valves, Check Valves
and Retrosetters**
Catalog Sections G and I



**Couplings for Service Line
Pipe and Tubing**
Catalog Section J



**Meter Couplings, Adapters,
Idlers and Other Accessories**
Catalog Section H



**Water Meter
Testing Equipment**
Catalog Section K

Frequently Asked Questions

What is the passivation process, and why is it important for all stainless steel products?

Stainless steel has a natural, passive, self-repairing chromium oxide film that forms on the outside surface as the result of a continual process of low-level oxidation. This passive layer gives stainless steels their corrosion resistance. Welding stainless steel compromises this film and leaves a residue that may prevent the reformation of the passive layer. The Ford passivation process consists of a chemical bath followed by a water rinse that removes welding residue and other foreign particles from the manufacturing process, thus allowing the formation of the passive layer to restore the stainless steel characteristics. For long-lasting durability, demand fully passivated stainless steel products.

What are Belleville washers, and why should they be used with products installed on HDPE pipes?

Belleville washers, also referred to as spring washers, are used on repair clamps, tapping sleeves and some saddles when installed on HDPE pipe to address outside diameter variations. When the pipe expands and contracts, Belleville washers promote a consistent force on the gasket. The Belleville washers are made of 17-7 PH stainless steel. Depending on the pipe size and recommended installation torque, Belleville washers are used singularly or in a stack to allow for more expansion/contraction of the pipe diameter. During initial installation, the Belleville washer(s) will compress. If the pipe diameter expands, the washer(s) will continue compressing. As the pipe diameter constricts, the washer(s) will decompress (or spring back to a cupped shape), keeping consistent force on the components to maintain the gasket compression.

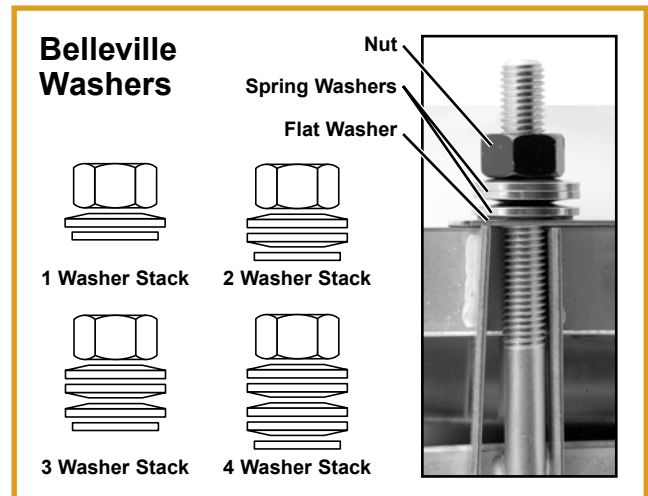

What is e-coat, and how does it differ from standard epoxy coating?

The electrocoat, or E-coat process is more than a standard epoxy coating. It consists of a complete protection package of surface preparation, secondary conversion coating, and a primary epoxy top coating. E-coat is an electrostatically applied, cationic epoxy coating that surrounds the iron component and provides lasting protection and durability. This 3-step process involves utilizing electrical current to drive positively charged epoxy onto a negatively charged metal part.

1. **UNIQUE SURFACE PREPARATION** – The pretreatment operation includes a thorough surface cleaning to remove contaminants and oils. Following cleaning, a conversion coating is applied to prepare the metal for epoxy bonding. The conversion coating acts as a separate protective layer.
2. **ELECTROSTATIC APPLICATION** – Following pretreatment, the epoxy coating is electrostatically applied. The part is negatively charged and submerged in a tank of positively charged epoxy particles. The charged epoxy is drawn to the part and adheres to all exposed surfaces, including hidden and difficult-to-reach areas.
3. **PROCESS COMPLETION** – Once fully covered, the part is cleaned to remove excess epoxy and then oven-cured to transform the epoxy particles into a uniform protective shell. E-coat's high quality black finish is resistant to damage from impact, abrasion and corrosion.

Electrocoat Process

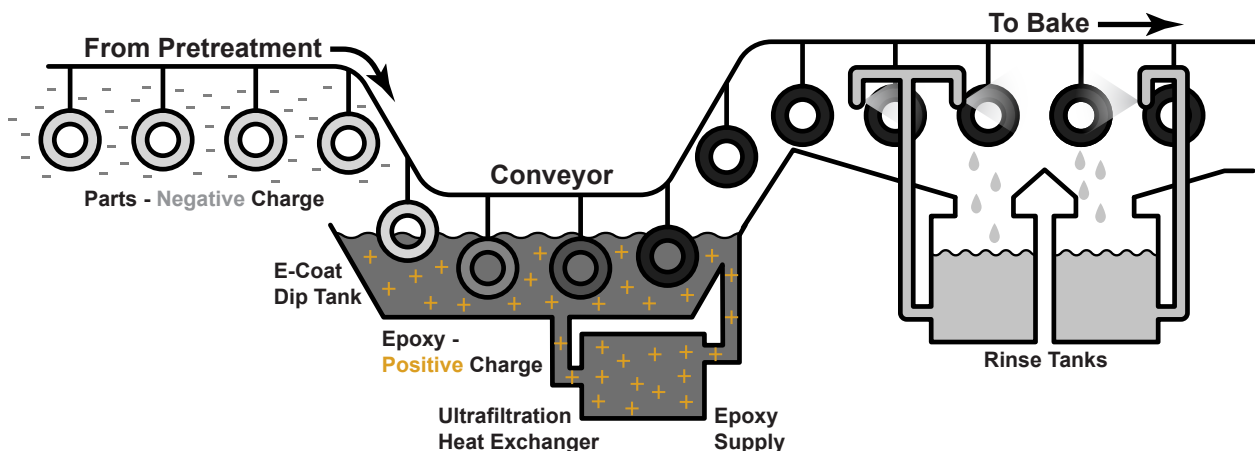

A few tools to help in the installation of your Ford Meter Box® pipeline products

Outside Diameter Tape

Commonly referred to as an OD tape, this specialized tape measure is used to easily calculate the exact outside diameter of a pipe. This is important information to note when ordering and installing any Ford Meter Box® pipeline product.

1.

After pipe is cleaned to smooth sealing surface and use supplied Ford Meter Box® OD tape.



2.

Snugly wrap OD Tape around pipe circumference.

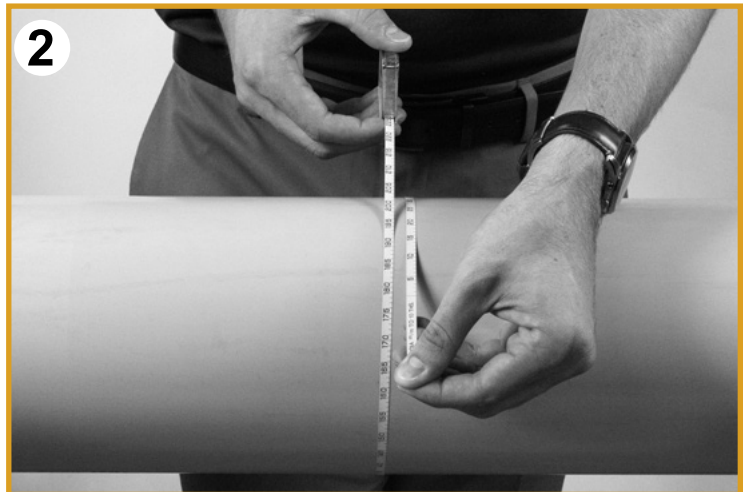

3.

Pipe OD is indicated where the first line matches up with the other side. In this case: 175mm



A few tools to help in the installation of your Ford Meter Box® pipeline products

Lubricant

Lubricant should be used when recommended on Ford Meter Box gaskets. Some products come pre-lubricated, while others require lubrication in the field. Properly applying lubricant ensures that the gasket will be able to slide over the pipe and itself without abrasions, creating a better seal and making installation easier.

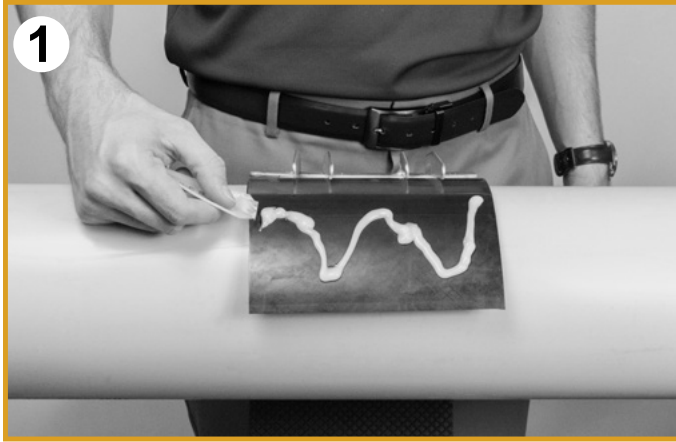

1.
Liberal apply lubricant to indicated area of gasket, based on product type.

2.
Ensure that the lubricant is covering the entire surface of the indicated gasket and pipe sealing surface.

3.
Complete installation of product as specified in installation instructions.



Torque Wrench

A torque wrench is used in the installation of most Ford Meter Box® pipeline products. It is specially calibrated to ensure proper torque when tightening. Using recommended torque values ensures that the product will perform as intended, without distorting the pipe or allowing leakage.



1.
Adjust the torque wrench by rotating the handle to the recommended torque value.



2.
Place on nut and tighten until hearing the torque wrench click.

Note: After each use, reset torque wrench to zero to maximize useful life of the tool.

Ford Meter Box[®]

Pipe Products for Metric Pipe

Warranty

All merchandise is warranted to be free from defects in material and factory workmanship for one year from date of shipment from our factory. We will provide, free of charge, new products in equal quantities for any that prove defective within one year from date of shipment from our factory. Manufacturer shall not be liable for any loss, damage, or injury, direct or consequential, arising out of the use of or the inability to use the product. Before using, user shall determine the suitability of the product for user's intended use and user assumes all risk and liability whatever in connection therewith. No claims for labor or consequential damage will be allowed. The foregoing may not be changed except by agreement signed by an officer of the manufacturer.

No other warranties are applicable or may be implied, including the implied warranty of merchantability and the implied warranty of fitness for particular purpose and any warranty relating to infringement or the like, all of which are disclaimed.

Please Note:

Consult the Ford Meter Box Company, Inc. website (www.fordmeterbox.com) for the most recent catalog information. The Ford Meter Box Company considers the information in this catalog to be correct at the time of publication. Items and option availability, including specifications, are subject to change without notice. Please verify that your product information is current.



The Ford Meter Box Company, Inc. 775 Manchester Avenue, P.O. Box 443, Wabash, Indiana, USA 46992
Telephone: 260.563.3171 • FAX: 1.800.826.3487 • Overseas FAX: 260.563.0167 • fordmeterbox.com