



# **ZIDONG PUMP**

## **HEAVY DUTY SLURRY PUMP**

- ★ Mining Tailings Disposal
- ★ Pipeline Transport
- ★ Mineral Processing
- ★ High Velocity Hydraulic Transport
- ★ Cyclone Feed
- ★ Aggregate Processing
- ★ Fine Primary Mill Grinding
- ★ Chemical Slurry Service
- ★ Pulp and Paper
- ★ Secondary Grinding
- ★ Sand & Gravel Transport
- ★ Dredging





## **ZIDONG PUMP<sup>®</sup> is a leading professional wear-resistant pump manufacturer and a customized pump solution provider !**

ZIDONG PUMP is a leading manufacturer of wear-resistant pumps and a trusted provider of customized pumping solutions.

Hebei Zidong Pump Industry Co., Ltd specializes in high-performance slurry pumps and parts, serving industries worldwide. With decades of expertise, we design and manufacture slurry pumps, gravel pumps, and sand dredging pumps with corrosion- and wear-resistant liners, ensuring durability in mining, mineral processing, the power sector, and general industries.

At Zidong Pump, we operate a state-of-the-art factory, equipped with CNC machining centers, advanced laboratories, and a rigorous quality control team. We have obtained ISO 9001 quality management certification and CE certification, guaranteeing that our products meet international standards. By utilizing computational fluid dynamics (CFD) technology, we optimize hydraulic performance, while our superior materials ensure maximum efficiency even in highly abrasive conditions.

To drive innovation, we have introduced the American Olympus handheld spectrometer and 3D scanning technology and established an advanced performance testing center. Our mission is to develop high-efficiency, long-life, and low-power-consumption pumps, helping customers reduce total maintenance costs and improve operational reliability.

With a strong commitment to quality and global reach, Zidong Pump exports its products to over 50 countries, including North America, South America, Europe, Africa, Southeast Asia, and the Middle East. Our pumps have earned high praise from clients worldwide for their superior performance and reliability.

At Zidong Pump, we are not just a manufacturer—we are your most trusted partner in pumping solutions.







# Our product range

For Mining and Slurry Applications



## Series ZH

Transporting the strong abrasive slurry with high concentration pH 5-12, metal lined

## Series ZHR

Transporting the abrasive corrosive slurry with high concentration, rubber lined

## Series ZHH

Delivering the abrasive slurry to reach the high head pH 5-12, metal lined

## Series ZM

Delivering the slurry with middle concentration pH 5-12, metal lined

## Series ZL

Delivering the slurry with middle concentration pH 5-12, metal lined

## Series ZG(H)

Transporting the sand and gravel or big capacity with high head and single casing construction.

## Series ZP

Delivering the slurry from the pond, being installed vertically submerged under the slurry

## Series ZPR

Delivering the slurry from the pond, being installed vertically, submerged under the slurry

## Series ZF

Multiple tank materials are available, which can improve the pumping efficiency for handling foam - rich media.

## Series ZN

Robust design with stronger performance for mud and dredging applications.

## Typical applications

- Mining and mineral processing
- Extra heavy duty highly abrasive slurries
- Cyclone feed
- Mine refuse and tailings
- Industrial processing
- Mill discharge
- Sand and gravel
- Medium duty abrasive slurries
- In plant slurry transfer pumps



**ZIDONG PUMP**® Heavy Duty Slurry Pumps are designed for long life, efficient operation, and ease of maintenance resulting in a lower total cost of operation.

Pumps are available with either Rubber, Metal, Ceramic lining or Tungsten coating, using Abrasive and Corrosive Resistant Materials.

#### Bearing Assembly and Shaft

- The shaft is designed with a short overhang to:
  - Reduce shaft deflection
  - Minimize vibration
- Provided with hardened shaft sleeve to protect the shaft.
- Optional dimensionally interchangeable heavy duty bearing assemblies.
- Bearing assembly is retained on a one piece frame.
- Grease purged piston rings to help seal contaminants out of bearing housing.

#### Impeller

- Enclosed impellers to maximise efficiency
- Pump out vanes on both shrouds
  - Minimizes recirculation
  - Reduces stuffing box pressure
- High Chrome, Ceramic or Elastomer liquid ends
- Interchangeable hard metal, ceramic and elastomer impellers
- Impeller clearance set by moving bearing assembly

#### Double casing with radial split outer casing

- Easy of assembly and disassembly of liquid end
- Optional construction for higher working pressures
- Removable liners are positively attached with fasteners

#### Dynamic Seals

- Reduces or eliminates the need for seal water
- Reduces sleeve wear and possible bearing failure

#### Removable Liners

- Removable High Chrome, Elastomer, Ceramic and Tungsten coated liners can be independently replaced, which minimises maintenance costs.

#### Configuration and Materials Options

	STANDARD	OPTIONAL
<b>LINERS</b>	High Chrome Natural Rubber	Special PH Alloy Urethane, Ceramic
<b>IMPELLERS</b>	High Chrome Natural Rubber	Special PH Alloy Urethane, Ceramic
<b>CASING</b>	Cast Iron	Ductile Iron
<b>SHAFT SEAL</b>	Packed Gland High/Low Flow	Expeller Mechanical Seal

An optional heavy duty bearing assembly is available from ZIDONG Pumps for applications where additional power or bearing loading is required.

STD. BEARING ASSY		HD. BEARING ASSY	
Size	KW Max	Size	KW Max
C	30	CC	55
D	60	DD	110
E	120	EE	225
F	260	FF	425
G	600	S	560
GG	900	U	2000
T	1200		



ZH 4/3 slurry pump delivering fine coal to de-watering screen.

**Mining & Mineral Processing • Power Plants • Cyclone Feed  
Oil & Gas • Sand & Gravel • Potato & Sugar Beet**



# ZH Series Heavy Duty Slurry Pump



There are heavy duty slurry pumps for a range of mill duties, from dirty water to the most difficult water - flushed crusher services.

The ZH series pump is the world's standard for the most difficult mill duties. It has a wide variety of applications. The pump provides excellent wear life while maintaining efficiency during the wear cycle, resulting in low total operating costs. It provides a complete selection for most duties in the mill. From cyclone feed to regrind, flotation and tailings, the ZH pump is the best choice.

Size range (discharge)  
1" to 18" (25mm to 450mm)

Capacities to  
22,000gpm (5,000m³/hr)

Heads to  
240ft (73m)

Pressures to  
300psi (2,020kpa)

Single stage, single suction, overhang shaft, centrifugal, double-casing horizontal pump; Wet ends are made of abrasive resistant hard metal or rubber.

## ★ Production Overview

The type of ZH(R) series pumps is cantilevered, horizontal, centrifugal slurry pumps. They are designed for handling highly abrasive, high - density slurry in the metallurgical, mining, coal, power, building material and other industrial departments etc. The pumps of this type may also be installed in multistage series. The frame plates for type ZH pumps have replaceable wear - resistant metal liners or rubber liners. The impellers are made of wear - resistant metal or rubber. The frame plate liner and impeller for ZHH pump are made of wear - resistant metal only. The shaft seals for type ZH pumps may use gland seal or expeller seal. The discharge branch can be positioned at intervals of 45 degrees upon request and oriented to any eight positions to suit installations and application.

## Main Usages

They are mainly used to pump high - hardness, strongly - corrosive and high - concentration liquids that contain suspended solid particles, such as finished ores, refuse ores, ashes, cinders, cements, mud, mineral stones etc. in the industry of metallurgy, mining, coal, power, building material etc. The temperature of the pumped solid - liquid mixture should be less than or equal to 80 °C, and the weight concentration should be less than or equal to 60%.

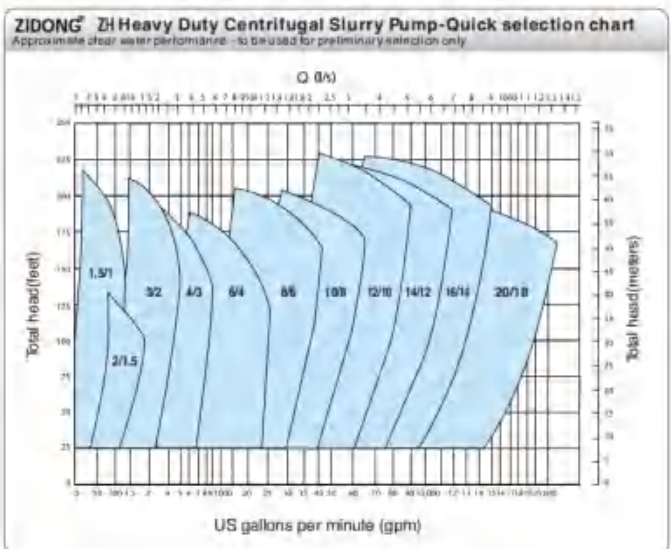

DC drive

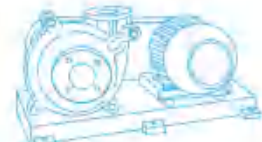

CR/CL drive



CV drive

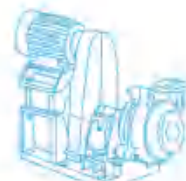

ZVZ drive

ZIDONG ZH (heavy duty) metal-lined pump

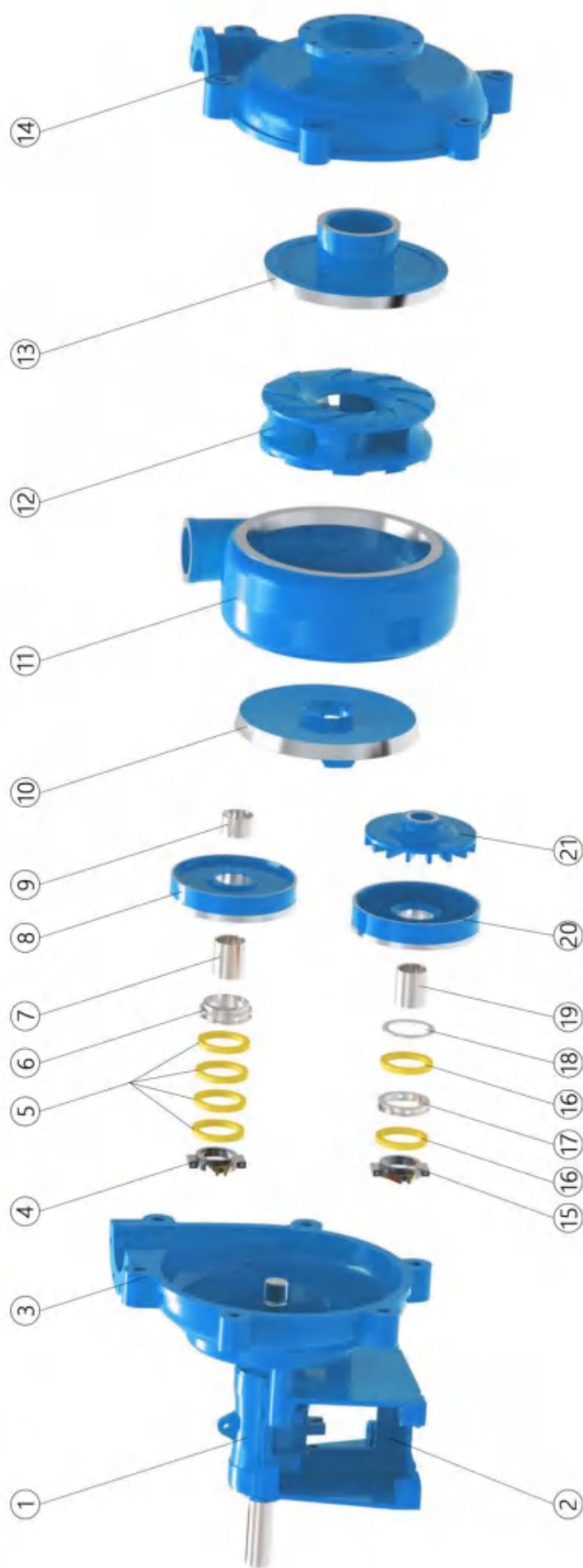

Other sealing arrangements available:  
Mechanical Seal

ITEM	QTY	DESCRIPTION
1	1	Bearing Assembly
2	1	Base
3	1	Frame Plate
4	1	Gland
5	4	Packing
6	1	Lantern Restrictor
7	1	Shaft Sleeve
8	1	Stuffing Box
9	1	Shaft Spacer
10	1	FPL Insert
11	1	Volute Liner
12	1	Impeller
13	1	Throat Bush
14	1	Cover Plate

ITEM	QTY	DESCRIPTION
15	1	Gland
16	2	Packing
17	1	Lantern Ring
18	1	Neck Ring
19	1	Shaft Sleeve
20	1	Expeller Ring
21	1	Expeller
22	1	Shaft Sleeve
23	1	Mechanical Seal Housing
24	1	Mechanical Seal





# ZIDONG ZHR (heavy duty) elastomer-lined pump



Other sealing arrangements available:  
Mechanical Seal

ITEM	QTY	DESCRIPTION
1	1	Bearing Assembly
2	1	Base
3	1	Frame Plate
4	1	Gland
5	4	Packing
6	1	Lantern Restrictor
7	1	Shaft Sleeve
8	1	Stuffing Box
9	1	Shaft Spacer
10	1	Frame Plate Liner
11	1	Impeller
12	1	Cover Plate Liner
13	1	Throat Bush
14	1	Cover Plate
15	1	Gland

ITEM	QTY	DESCRIPTION
16	2	Packing
17	1	Lantern Ring
18	1	Neck Ring
19	1	Shaft Sleeve
20	1	Expeller Ring
21	1	Expeller
22	1	Shaft Sleeve
23	1	Mechanical Seal Housing
24	1	Mechanical Seal



## ZH Series Metal Liner Slurry Pump Specification

MODEL	MAX POWER (kw)	CLEAR WATER PERFORMANCE				
		CAPACITY	HEAD	SPEED	MAX.Eff	NPSH
		(m³/h)	h(m)	n(r/min)	η%	(m)
ZH-1.5/1B	15	12.6~28.8	6~68	1200~3800	40	2~4
ZH-2/1.5B	15	32.4~72	6~58	1200~3200	45	3.5~8
ZH- 3/2C	30	39.6~86.4	12~64	1300~2700	55	4~6
ZH- 4/3C	30	86.4~198	9~52	1000~2200	71	4~6
ZH- 4/3D	60					
ZH- 6/4D	60	162~360	12~56	800~1550	65	5~8
ZH- 6/4E	120					
ZH- 8/6E	120	360~828	10~61	500~1140	72	2~9
ZH-10/8ST	560	612~1368	11~61	400~850	71	4~10
ZH-12/10ST	560	936~1980	7~68	300~800	82	6
ZH- 14/12ST	560	1260~2772	13~63	300~600	77	3~10
ZH- 16/14ST	560	1368~3060	11~63	250~550	79	4~10
ZH- 16/14TU	1200					
ZH- 18/16ST	560	2160~5040	8~66	200~500	80	4.5~9
ZH- 18/16TU	1200					
ZH- 20/18TU	1200	2520~5400	13~57	200~400	85	5~10

## ZHR Rubber Liner Slurry Pump Specification

MODEL	CLEAR WATER PERFORMANCE					
	MAX POWER	CAPACITY	HEAD	SPEED	MAX.Eff	NPSH
	(kw)	(m³/h)	h(m)	n(r/min)	(η%)	(m)
ZHR-1.5/1B	15	10.8~25.2	7~52	1400~3400	35	2~4
ZHR-2/1.5B	15	25.2~54	5.5~41	1000~2600	50	2.5~5
ZHR-3/2C	30	36~75.6	13~39	1300~2100	55	2~4
ZHR-4/3C	30	79.2~180	5~34.5	800~1800	59	3~5
ZHR-4/3D	60					
ZHR-6/4D	60	144~324	12~45	800~1350	65	3~5
ZHR-6/4E	120					
ZHR-8/6E	120	324~720	7~49	400~1000	65	5~10
ZHR-10/8ST	560	540~1188	12~50	400~750	75	4~12
ZHR-12/10ST	560	720~1620	7~45	300~650	80	2.5~7.5
ZHR-14/12ST	560	1152~2520	13~44	300~500	79	3~8

Note:

1. Parameter range recommended:  $50\%Q' \leq Q \leq 110\%Q'$  ( $Q'$  Appropriate to capacity at highest efficiency point).
2. NPSH: appropriate to point Q recommended at highest speed.



# ZHH Series High Head Slurry Pump

## Heavy duty high head lined slurry pump

The ZHH series pump is designed to produce high heads per stage at high pressures. Commonly used for long distance transport lines, the ZHH pump can often satisfy application duties with a single pump where others require multiple pumps in series.

**Size range (discharge)**  
1" to 6" (25mm to 150mm)

**Capacities to**  
4500gpm (1025m³/hr)

**Heads to**  
325ft (100m)

**Pressures to**  
750psi (5170kpa)

Single stage, single suction, overhang shaft, centrifugal, double-casing horizontal pump. Wet ends are made of abrasive resistant hard metal.

- ★ **BASE** -A single - piece base, which is integrated with an adjustment mechanism for impeller clearance in the pump - bearing assembly, locks into the base using four heavy - duty bolts.
- ★ **BEARING ASSEMBLY** -All bearings are assembled with highest - quality tapered roller bearings in controlled environments to prevent lubricant and housing contamination. Oversized shaft diameter and reduced over - hang in the wet end contribute to long life and reliability in the field.
- ★ **CASING** -Split -case design allows for ease of access and maintenance on wet end parts. SG iron with extensive exterior ribbing provides increased pressure ratings and reliable service over time. Series pumping can be easily achieved with casing pressures rated to 750psi.
- ★ **WETTED PARTS**
- ★ **IMPELLERS** -Hardmetal impeller. Pump out vanes on the and front reduce recirculation within the pump and aid in preventing seal contamination. Optional castings of straight or semi - Francis vanes offer wider hydraulic options in single sizes.
- ★ **LINERS** -Heavy - duty hard metal liner with an actively engineered attachment mechanism to the casing via threaded bolts as opposed to unreliable glue.
- ★ **THROATBUSH** -Adjustable vie cotters to account for wear over time and increase efficiency.
- ★ **CHEMICAL COMPATIBILITY** -Operating PH range from 5 to 12.
- ★ **SEALS** -ZIDONG offers a wide variety of seal options to suit any process requirements.
- ★ **GLAND SEAL** -As the most popular and economical seal option, pflush water with certain pressure is injected into the packing to prevent slurry from leaking, and the gland seal is simple, easy to repair and costs less.
- ★ **EXPELLER SEAL (CENTRIFUGAL SEAL)**  
The rotating expeller generates negative force to prevent slurry from leaking. It is used in applications where suction pressure is no more than 10% of discharge pressure, such as single - stage pumps or the first stage of series pumps. The expeller seal needs no flush water, does not dilute the slurry, and seals better than the gland seal.
- ★ **MECHANICAL SEAL** -It is suited for high - seal applications such as chemical and food industries where any other materials are forbidden to be mixed into fluid. It costs more and is hard to fix.

**ZIDONG® ZHH Heavy Duty High Head Centrifugal Slurry Pump-Quick selection chart**  
*Approximate clear water performance - to be used for preliminary selection only*

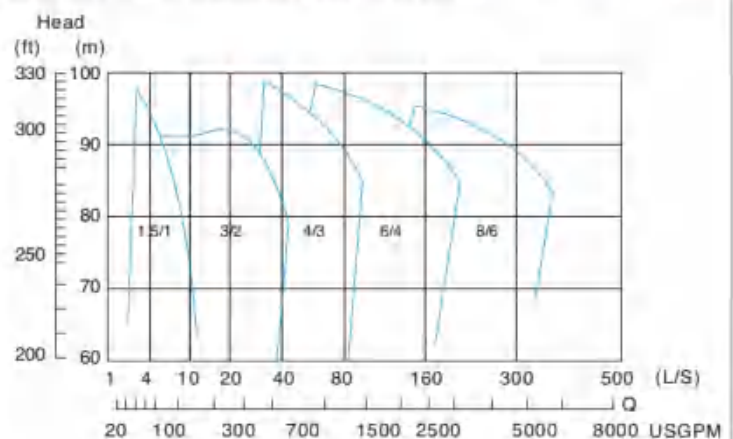

**Mining & Mineral Processing • Power Plants • Cyclone Feed  
Oil & Gas • Sand & Gravel • Potato & Sugar Beet**

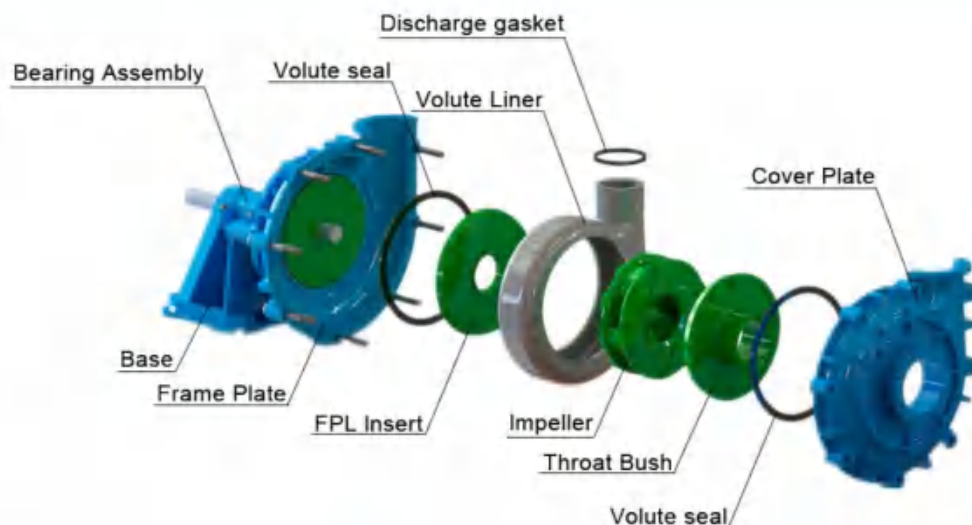

- ★ Pipeline Transport
- ★ High Velocity Hydraulic Transport
- ★ Mineral Processing
- ★ Coal Prep
- ★ Cyclone Feeds
- ★ Aggregate Processing
- ★ Fine Primary Mill Grinding
- ★ Chemical Slurry Service
- ★ Tailings
- ★ Secondary Grinding
- ★ Industrial Processing
- ★ Pulp And Paper
- ★ Food Processing
- ★ Cracking Operations
- ★ Ash Handling



## ZHH High Head Slurry Pump

ZHH METAL LINED HIGH HEAD SLURRY PUMP							
MODEL	MAX. POWER (kw)	CLEAR WATER PERFORMANCE					
		Q CAPACITY		HEAD h(m)	SPEED n(r/min)	MAX.Eff η%	NPSH (m)
		(m³/h)	(l/s)				
ZHH-1.5/1C	30	16.2~34.2	4.5~9.5	25~92	1400~2200	20	2~5.5
ZHH-3/2D	60	68~136.8	19~38	25~87	850~1400	47	3~7.5
ZHH-4/3E	120	126~252	35~70	12~97	600~1400	50	2~5
ZHH-6/4F	260	324~720	90~200	30~118	600~1000	64	3~8
ZHH-8/6S	560	468~1008	130~280	20~94	500~1000	65	4~12
ZHH-10/8T	1200	576~1152	160~320	32~95	450~725	65	6~10

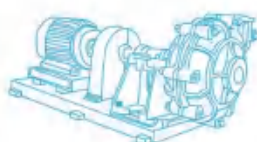

DC drive

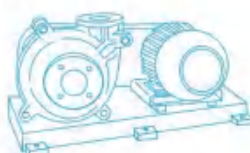

CR/CL drive



CV drive

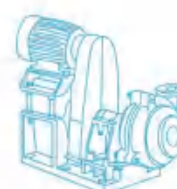

ZVZ drive



## ZH(R) ZHH Dimensions

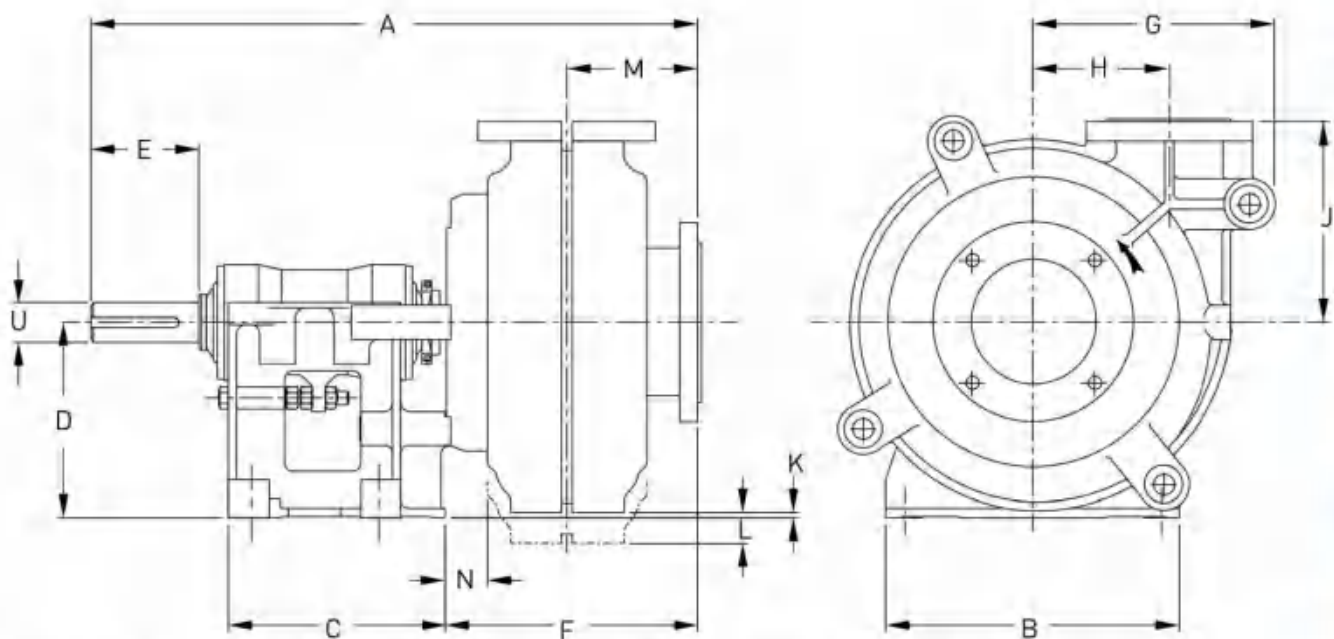

Note: Drawing is indicative only and does not accurately represent how pumps of all sizes will appear.

Model	Dimensions(mm)															Weight(kg)	
	A	B	C	D	Key	E	F	G	H	J	K	L	M	N	U	Metal	Rubber
1.5/1B-ZH(R)	583	295	248	197	8x7	79	206	181	98	171	-	46	106	19	28	88	77
1.5/1C-ZHH	759	406	311	254	12x8	121	306	270	194	254	-	11	121	66	42	318	-
2/1.5B-ZH(R)	592	295	248	197	8x7	79	217	203	114	184	33	-	114	22	28	156	118
3/2C-ZH(R)	768	406	311	254	12x8	121	280	238	138	210	71	-	151	40	42	197	154
3/2D-ZHH	986	492	364	330	18x11	164	389	384	254	268	-	51	203	83	65	750	-
4/3C-ZH(R)	843	406	311	254	12x8	121	353	292	149	262	24	-	187	54	42	249	236
4/3D-ZH(R)	943	492	364	330	18x11	164	353	292	149	262	100	-	187	52	65	318	290
4/3E-ZHH	1240	622	448	457	22x14	222	492	492	330	432	-	12	248	79	80	1250	-
6/4D-ZH(R)	1021	492	364	330	18x11	164	424	406	229	338	11	-	219	65	65	669	45
6/4E-ZH(R)	1178	622	448	457	22x14	222	433	406	229	338	138	-	219	75	80	885	635
6/4F-ZHH	1556	857	634	610	28x16	279	585	616	413	546	-	134	305	75	100	3420	-
8/6E-ZH(R)	1302	622	448	457	22x14	222	557	551	318	460	-	62	292	82	80	1497	982
8/6F-ZH(R)	1507	857	635	610	28x16	279	539	551	318	460	90	-	292	65	100	1814	1390
8/6S-ZHH	2275	1150	1040	650	36x20	350	852	835	584	813	-	160	394	-	150	6900	-
8/6F-ZH(R)	1646	991	705	610	28x16	279	683	673	419	635	-	12	333	134	100	3193	2581
10/8ST-ZH(R)	1748	1150	780	650	32x18	280	692	673	419	635	27	-	333	143	120	3742	3130
10/8F-ZH(R)	1721	991	705	610	28x16	279	753	756	464	673	-	104	381	108	100	3760	2808
10/8ST-ZH(R)	1816	1150	780	650	32x18	280	762	755	464	673	-	65	381	117	120	4309	3357
12/10F-ZH(R)	1772	991	705	610	28x16	279	803	937	629	832	-	263	406	105	100	5847	4123
14/12ST-ZH(R)	1873	1150	780	650	32x18	280	812	937	629	832	-	224	406	114	120	6396	4672
16/14TU-ZH(R)	2320	1460	1050	900	36x20	350	953	1048	660	889	-	84	451	167	150	9979	-
20/18TU-ZH(R)	2475	1460	1050	900	36x20	350	1100	1420	940	1230	-	420	480	210	150	18864	15921

# ZM Series Metal Slurry Pump

## Introduction

ZM series slurry pumps are cantilevered, horizontal, centrifugal type.

ZM series pumps are adopted high speed operating so they have small volumes saving floor area.

The discharge position by request may be rotated eight different angles at internal of 45 degrees for installation and application.



## Model meaning

**ZM-10/8E**

Z-ZIDONG

M-Middle concentration

10-Suction size(inch)

8-Discharge size (inch)

E-Frame type with maximum power

## Application

They are suitable for delivering middle abrasive, middle-density slurries for metallurgical, mining, coal and building material departments.

The shaft seal is adopted both gland seal and expeller seal.

MODEL	MAX POWER (kw)	CLEAR WATER PERFORMANCE				
		CAPACITY	HEAD	SPEED	MAX.Eff	NPSH
		(m³/h)	h(m)	n(r/min)	η%	(m)
ZM-10×8E	120	540-1440	14-60	600~1000	73	4~10
ZM-10×8R	300					

**Mining & Mineral Processing • Power Plants • Cyclone Feed  
Oil & Gas • Sand & Gravel • Potato & Sugar Beet**



# ZL(R) Series Metal Slurry Pump



## Introduction

ZL(R) series are cantilevered, horizontal, centrifugal slurry pumps. ZL(R) series pumps are adopted high speed operating so they have small volumes saving floor area.

The frame plates have changeable, wear-resistant, metal liners or rubber liners and the impellers are made of wear resistant metal or rubber (rubber for frame plates, impellers of pumps with discharge Dia. (mm) above 550mm).

The discharge position by request maybe rotated eight different angles at internal of 45 degrees for installations and application.

## Model meaning

**ZL(R)-20A**

Z-ZIDONG

L-Low concentration

R-Rubber lined

20-Discharge size (mm)

A-Frame type with maximum power

## Application

They are suitable for delivering low abrasive, low density slurries for metallurgical, mining, coal and building material departments. The shaft seal is adopted both gland seal and centrifugal seal.



**Mining & Mineral Processing • Power Plants • Cyclone Feed  
Oil & Gas • Sand & Gravel • Potato & Sugar Beet**

## ZL(R) Slurry Pump Specifications

MODEL	MAX POWER (kw)	MATERIAL		CLEAR WATER PERFORMANCE					
		LINER	IMPEL	Q CAPACITY		HEAD	SPEED	MAX.Eff	NPSH
				m³/h	l/s	h(m)	n(r/min)	η%	(m)
ZL-20A	7.5	M	M	2.34~10.8	0.65~3	6~37	1400~3000	30	2~3
ZLR-20A	7.5	M	RU	2.16~9	0.6~2.5	7~32	1600~3000	30	3~5
ZL-50B	15	M	M	16.2~76	4.5~20	9~44	1400~2800	55	3~5
ZLR-50B	15	RU	RU	12.6~60	3.5~17.6	6~38	1200~2600	48	3~6
ZL-75C	30	M	M	18~151	5~42	4~45	900~2400	57	3~6
ZLR-75C	30	M	RU	25~144	7~40	9~43	1000~2200	60	3~5
ZL-100D	60	M	M	50~252	14~70	7~46	800~1800	60	2~3.5
ZLR-100D	60	RU	RU	61~252	17~70	8~38	800~1600	65	2~5
ZL-150E	120	M	M	115~486	32~135	12~51.5	800~1500	65	2~6
ZLR-150E	120	RU	RU	137~486	38~135	10~36.5	800~1300	65	2.5~5.5
ZL-200E	120	RU	RU	216~990	60~275	7~42.5	500~1100	74	3~6
ZLR-200E	120	M	M	234~910	65~253	9.5~40	600~1100	64	3~6
ZL-250F	260	M or RU	M	396~1425	110~396	8~30	500~800	77	2~10
ZLR-250F	260	RU	RU	324~1314	90~365	8~30	500~800	70	5~10
ZL-300S	560	M	M	468~2538	130~705	8~60	400~950	79	2~10
ZLR-300S	560	RU	RU	432~1900	120~528	7~41	400~800	81	3~8
ZL-350S-L	560	M	M	650~2800	180~780	10~59	400~840	81	3~10
ZLR-350S	560	RU	RU	720~2844	200~790	10~41	400~700	86	3~7
ZLR-400ST	560	RU	RU	756~3312	210~920	7~37.5	300~600	85	2~8
ZL-400ST	560	M	M	720~3312	200~920	7~51	300~700	80	2~10
ZLR-450ST	560	RU	RU	1080~4356	300~1210	9~40	300~550	87	3~10
ZL-450ST	560	M	M	1008~4356	280~1210	9~48	300~600	80	2~9
ZL-550TU	1200	M	M	1980~7920	560~2200	10~50	250~475	86	4~10
ZLR-650TU	2000	RU	RU	2520~9108	700~2530	10~39	200~350	86	2~8

Note:

1. Parameter range recommended:  $50\%Q' \leq Q \leq 110\%Q'$  ( $Q'$  Appropriate to capacity at highest efficiency point).
2. NPSH: appropriate to point Q recommended at highest speed.



# “ ZP(R) Series Sump Slurry Pump ”

The ZP(R) series pump is ideal for a variety of submerged suction pumping applications. These pumps operate well in a variety of sump conditions, and can also be readily applied on floating dewatering or other floating pump platforms.

As a true cantilevered pump, the ZP(R) series does not have submerged bearings or seals; thus, eliminating the primary failure mechanism for similarly fielded pump lines.

Size range (discharge)  
1.5" to 10" (40mm to 250mm)

Capacity  
to 5,060gpm (1,150m<sup>3</sup>/h)

Head  
to 120ft (37m)

**ZIDONG® ZP Heavy Duty Sump Pump-Quick selection chart**  
Approximate clear water performance - to be used for preliminary selection only

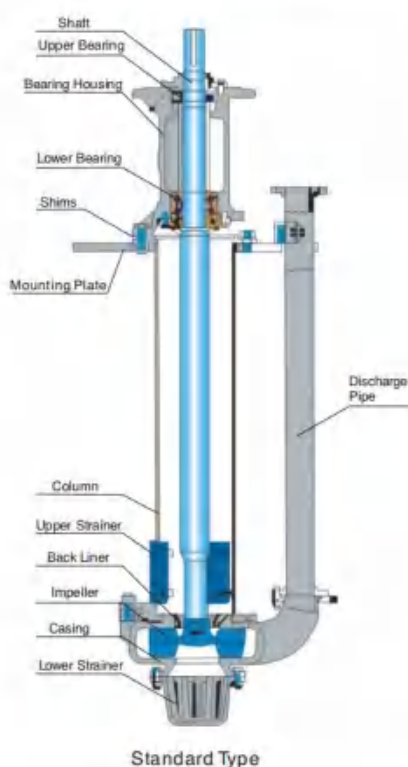
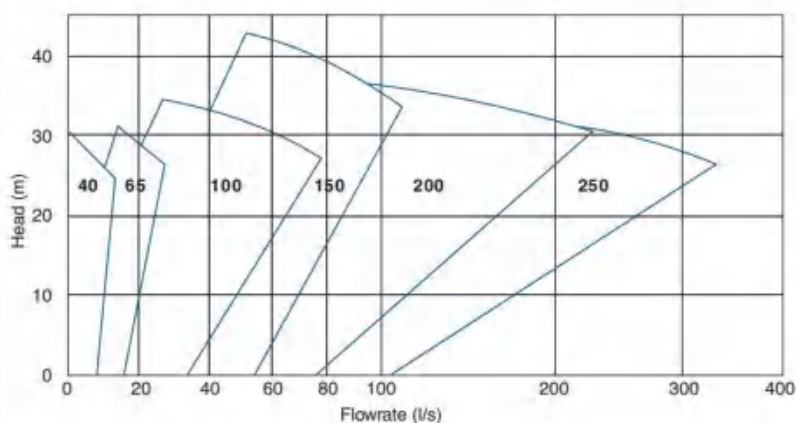

Standard Type

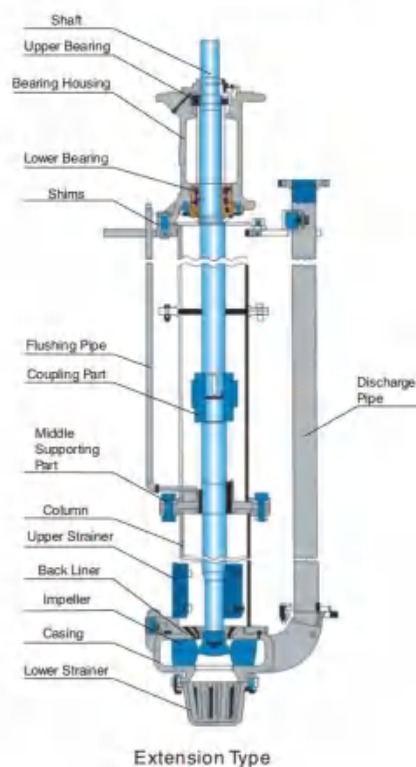

Extension Type



- ★ **CASING** -The metal pumps have a heavy walled abrasive resistant chrome alloy casing. Rubber pumps have a molded rubber casing adhered to sturdy metal structures.
- ★ **BEARING ASSEMBLY** - Our maintenance friendly bearing assembly has heavy duty roller bearings, robust bearing housings, and a massive shaft.
- ★ **STANDARD IMPELLER** - Open impellers; fluid flow enters the top as well as the bottom. This design eliminates shaft seals and reduces thrust load on the bearings.
- ★ **LARGE PARTICLE** - Large particle impellers are also available and enable passing unusually large solids.

- ★ Continuous or "Snore" Sump Pump Operation
- ★ Abrasive Slurries
- ★ High Density Slurries
- ★ Large Particle Slurries
- ★ Sump Drainage
- ★ Washdown
- ★ Floor Drainage
- ★ Mixing



## ZP(R) Sump Slurry pump Specifications

ZP/ ZPR CLEAR WATER PERFORMANCE								
MODEL	MAX. POWER (kw)	MATERIAL		Q CAPACITY		HEAD h(m)	SPEED n(r/min)	MAX.Eff η%
		LINER	IMPEL	(m³/h)	(l/s)			
ZP-40PV	15	M	M or RU	19.44~43.2	5.4~12	4.5~28.5	1000~2200	40
ZPR-40PV	15	RU	RU	17.28~39.6	4.8~11	4~26	1000~2200	40
ZP-65QV	30	M	RU	23.4~111	6.5~30.8	5~29.5	700~1500	50
ZP-65QV	30	M	M	19.8~93.06	5.5~25.85	5~29.5	700~1500	40
ZP-65QV	30	M	M	23.4~87.12	6.75~24.2	5.5~31.5	700~1500	58
ZPR-65QV	30	RU	RU	22.5~105	6.25~29.15	5.5~31.5	700~1500	51
ZP-65QV	30	M	M	18.9~89.1	5.25~24.75	5~28	700~1500	35
ZP-100RV	75	M	RU	56.7~221.76	15.75~61.9	4.5~34.5	500~1200	56
ZP-100RV	75	RU	RU	64.8~285	18~79.2	7.5~36	600~1200	62
ZPR-100RV	75	M	M	54~289	15~80.3	5~35	500~1200	56
ZP-100RV	75	M	M	54~237.6	15~66	6~30	600~1200	40
ZP-150SV	110	M	RU	108~479.16	30~133.1	8.5~40	500~1000	52
ZP-200SV	110	M	M or RU	189~891	52.5~247.5	6.5~37	400~850	64
ZP-250TV	200	M	M or RU	261~1089	72.5~302.5	7.5~33.5	400~750	60
ZP-300TV	200	M	RU	288~1267	80~352	6.5~33	350~700	50





“

## ZF Sesies Froth Pump

”

### Introduction

**Bearing Assembly-** Bearing assembly of ZF series is the same with that of ZP, ZPR series. Bearing housing is installed with motor frame base or suppo rting plate, i.e. pump and moto are connected either directly with coupling or through pulley and belt.

Pulleys can be exchanged conveniently to adjust the pump rotating speed to satisfy the varying operating condition.

**Feeding Tank-** Feeding tank can be steel, stainless steel or coated with rubber with overflow box and tangential inlet .

The former can transmit the excessive incoming slurry back to its pit, while the latter will allow the slurry quickly get into the pump body and make part of the foams disappear.



### Application

It can be widely used in metallurgical industrial, mining sector, coal ore and chemical engineering to handle abrasive and corrosive slurries with froth.

When operated, ZF pump can effectively eliminate foam and froth in slurry and will also function properly even with inadequate feeding slurry , thus making them the ideal choice for delivering foam slurries, especially, in flotation process.

## Construction drawing of froth pump

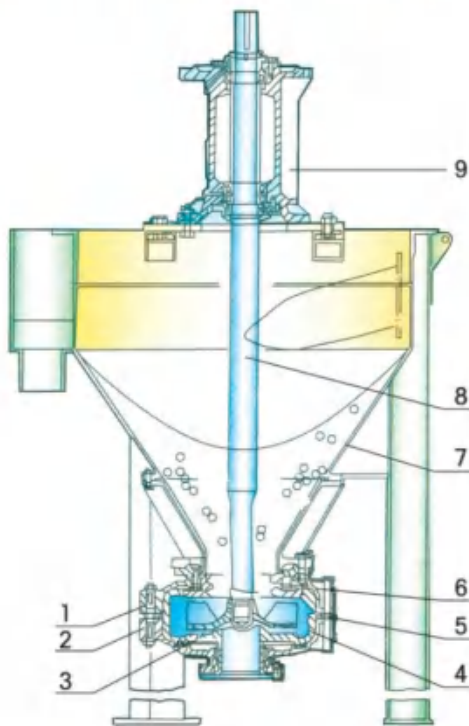

- 1. Frame plate
- 2. Cover plate
- 3. Cover plate liner insert
- 4. Volute
- 5. Impeller
- 6. Frame plate liner
- 7. Tank
- 8. Shaft
- 9. Bearing housing

## Froth pumps selection chart

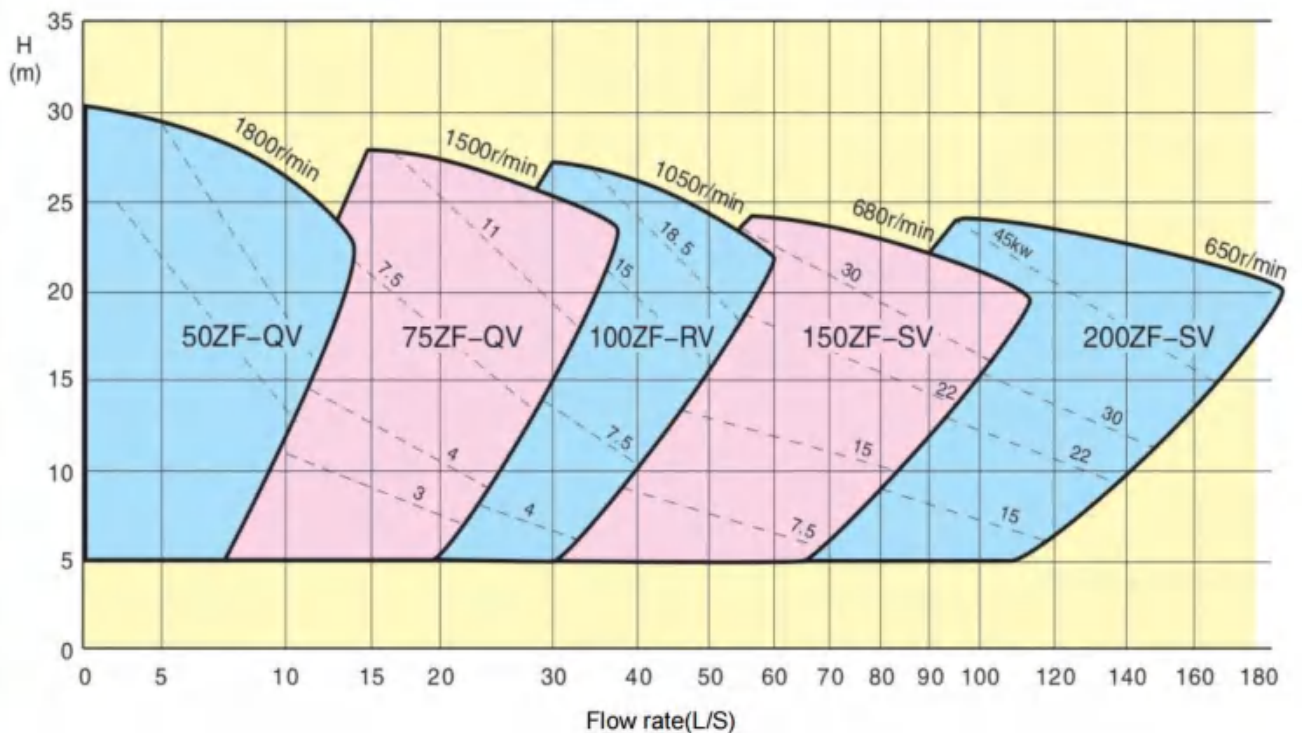

NOTE: Approximate performance for clear water is used for primary selection only.



# “ ZG(H) Series Sand & Gravel Pump ”

## Heavy duty pump for dredge and gravel applications

The ZG(H) series pump is designed for continuous pumping of highly abrasive slurries that containing large particles which the ZH and ZL series cannot handle, the large volume inside casing make it the best choice for gravel, dredging and other applications where large particles needed to be handled. Low NPSH requirement and robust design insures long life under the worst conditions.



ZIDONG® ZG Heavy Duty Dredge & Gravel Pumps-Quick selection chart  
Approximate clear water performance - to be used for preliminary selection only

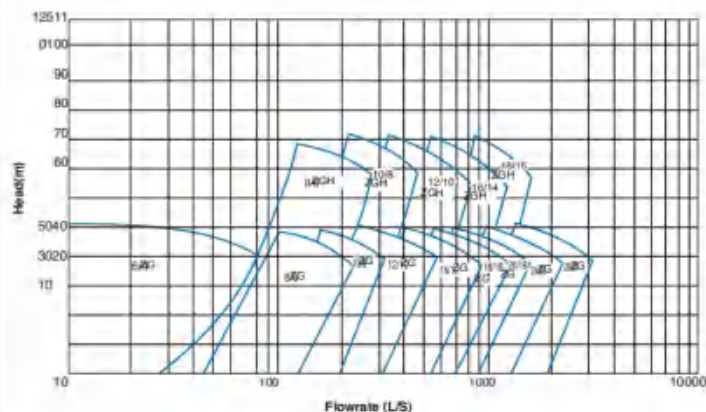



# Design Considerations

ZIDONG Gravel pumps are designed for long life, efficient operation and ease of maintenance. Gravel pumps have high-chrome wet ends with expeller or stuffing box seal arrangements.

## APPLICATION FEATURES

### Bearing assembly and shaft

- The shaft is designed with a short overhang to:
  - Reduce shaft deflection
  - Minimise vibration
- Provided with hardened shaft sleeve to protect the shaft
- Bearing assembly is retained on a one piece frame
- Grease-purged piston rings to help seal contaminants out of bearing housing

### Single casing with assembly clamps

- Easy assembly and disassembly of liquid end
- Clamp design facilitates rotation of volute
- Large volute reduces friction and wear
- Minimal parts + simple design

### Impeller

- Enclosed impellers to maximise efficiency
- Pump-out vanes on both shrouds
  - Minimises re-circulation
  - Reduces stung box pressure
- High chrome liquid ends
- Interchangeable hard metal impellers
- Impeller clearance is set by moving the bearing assembly
- High efficiency impeller optional

### Centrifugal seal option

- Reduces or eliminates need for gland service water
- Reduces sleeve wear and possible bearing contamination

An optional heavy duty bearing assembly is available for ZIDONG Pumps for applications where additional power or bearing loading is required.

STD. BEARING ASSy		STD. BEARING ASSy	
Size	kw max	Size	kw max
C	30	CC	55
D	60	DD	110
E	120	EE	225
F	260	FF	425

## Construction and Materials options

	STANDARD	OPTIONAL
LINERS	High chrome	Ultra chrome
IMPELLERS	High chrome Natural rubber	Ultra chrome, special pH alloy urethane, ceramic
GLAND	Cast Iron	Stainless Steel
SHAFT SEAL	Packed gland stuffing box or expeller seal	Mechanical seal

## Sectional Arrangement

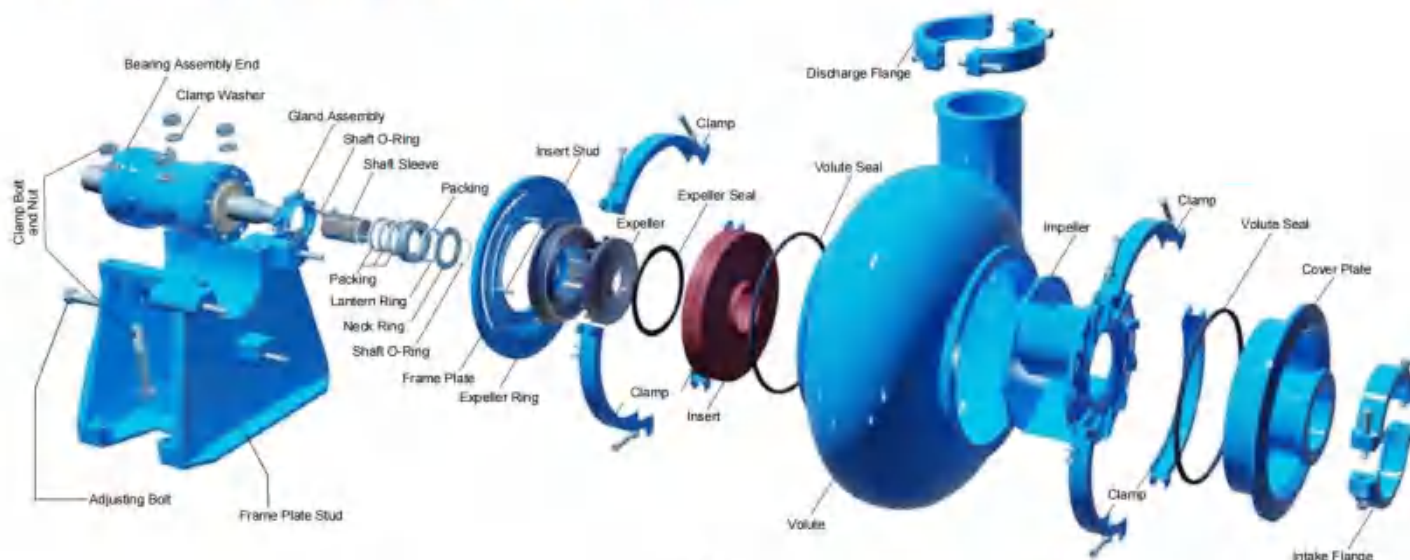



## ZG(H) Series Sand & Gravel Pump Specifications

MODEL	CLEAR WATER PERFORMANCE						
	MAX. POWER (kw)	Capacity (m <sup>3</sup> /h)	HEAD (m)	SPEED (r/min)	MAX. eff%	NPSH (m)	Max size passage (mm)
ZG-6/4D	60	36-250	3.5-51	600-1400	50	2.5-3.5	82
ZG-8/6E	120	180-540	10-48	800-1400	60	3-4.5	127
ZG-10/8F	260	180-820	13-50	500-1000	65	3-7.5	178
ZG-10/8S	560	180-820	13-50	500-1000	65	3-7.5	178
ZG-12/10G	600	360-1200	11-58	400-850	65	1.5-4.5	220
ZG-14/12G	600	500-3000	6-66	300-700	68	2-8	241
ZGH-10/8S	560	750-1300	18-80	500-950	72	2-5	180
ZGH-12/10G	600	1400-2700	28-78	350-700	73	2-10	210
ZGH-16/14TU	1200	700-3400	20-72	300-500	75	3-8	230
ZG-18/16TU	1200	700-4320	12-48	250-500	70	3-9	254
ZG-20/18TU	1200	1000-5400	8-50	200-400	68	3-6	330

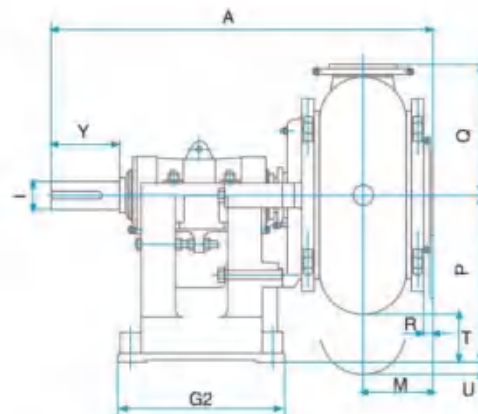
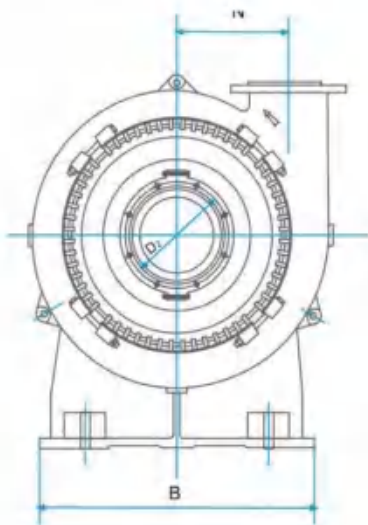

Model	A	B	D2	G2	I	M	N	P	Q	R	T	U	Y	Wt kg
ZG-6/4D	1006	492	260	-	65	203	260	330	343	33	16	-	164	460
ZG-8/6E	1286	622	324	-	80	295	352	457	405	29	54	-	222	1120
ZG-10/8F	1591	857	406	-	100	330	416	610	533	48	60	-	281	2250
ZG-10/8S	1720	920	406	780	120	330	416	450	533	48	-	102	280	2285
ZG-12/10G	2010	1207	470	876	140	368	522	851	665	48	238	-	356	4450
ZG-14/12G	2096	1207	495	876	140	424	610	851	787	48	121	-	356	5400
ZGH-10/8S	1774	920	406	780	120	330	475	450	620	48	-	206	280	3188
ZGH-12/10G	2062	1219	476	876	140	400	605	851	800	60	40	-	356	4638
ZGH-16/14TU	2367	1460	600	1050	150	448	765	900	1008	72	-	120	350	12247
ZG-18/16T	2320	1150	641	1040	150	439	692	650	921	65	-	274	350	7500
ZG-20/18T	2550	1460	696	1050	150	560	915	900	1067	114	-	130	359	11500

Note: All values are in millimeters (mm) except where noted

# ZN Series Dredge Pump

The ZN dredge pump is a new type of sludge pump researched and manufactured by our company based on International gravel pumps, aimed at rivers and seas in need of repair. The ZN pump is a single - stage single - suction cantilever horizontal centrifugal pump with advantages of light weight, good wear resistance, super dredging performance. It is perfectly suited for dredging in the whole construction project and offers multiple economic benefits, etc. It fully meets the requirements of dredging.



ZN500 Sand Dredge Pump Set



Underwater Dredge Pump



Dredge Pump Integrated Gear



## ZN Series dredge pump selection chart

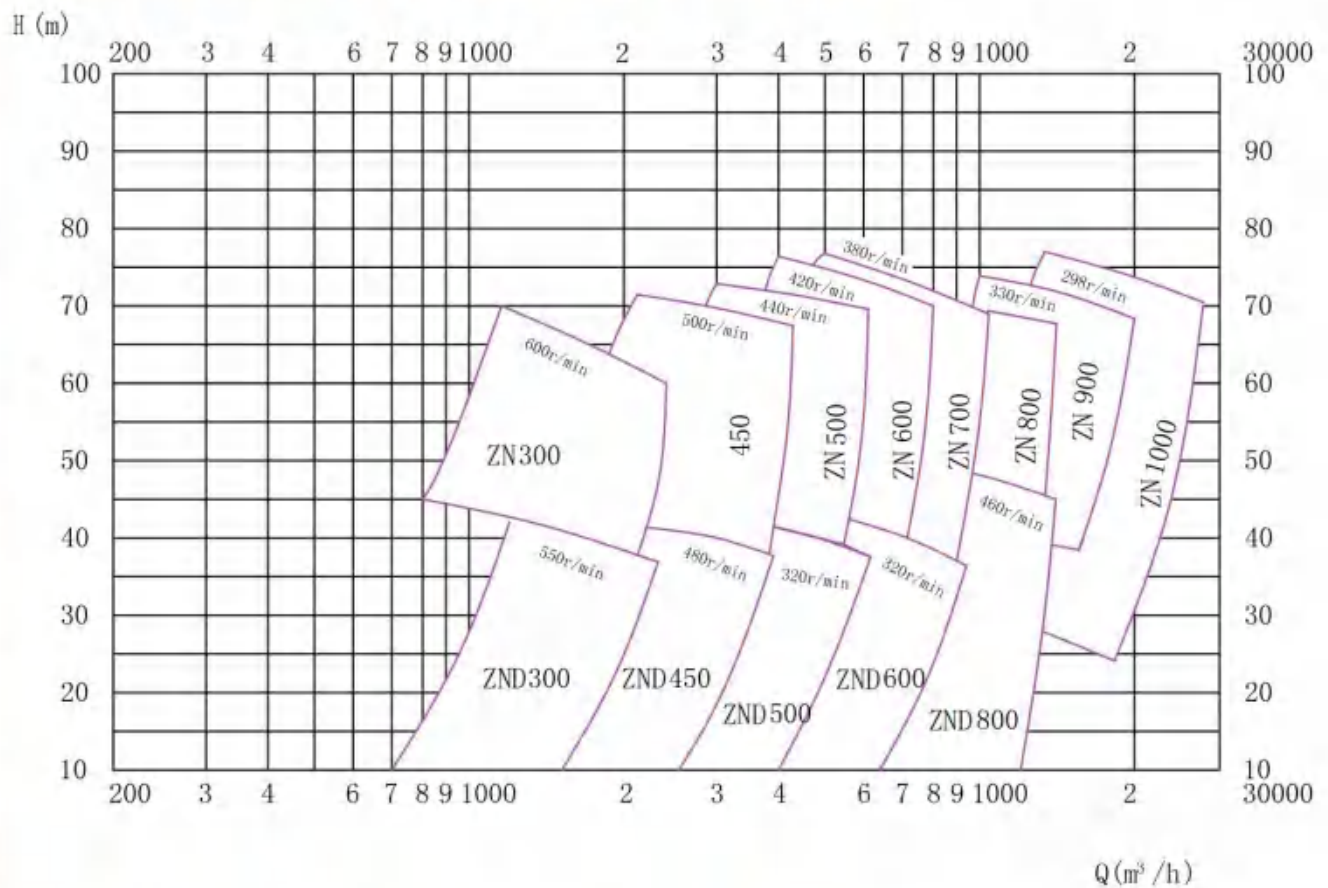

## ZN Series dredge pump specifications

Model	Capacity	Head	Speed	Efficiency $\eta(\%)$	NPSH (m)	Outlet/Inlet Diameter	Max Particles Size (mm)
	(m³/h)	h(m)	n(r/min)			(mm)	
ZN200	750-1000	40-65	700-850	70-72	4	200/250	180
ZN250	1100-1300	40-65	500-650	70-74	4	250/350	144
ZN300	1800-2200	40-65	400-550	74-78	4	300/450	200
ZN350	2600-3000	40-65	400-550	74-78	4.5	350/450	205
ZN400	2800-3200	20-40	400-550	74-78	4.5	400/450	200
ZN450	3200-3850	40-67	350-500	76-80	4.5	450/600	220
ZN500	4500-5500	40-65	350-450	78-80	4.8	500/650	230
ZN600	5000-9000	55-80	280-420	84-85	6	600/660	320
ZN700	8000-12000	60-85	280-380	83-85	6	700/760	380
ZN900	12000-19000	50-75	280-330	85-87	6	900/960	320
ZN1000	16000-25000	23-76	181-290	85-87	6	1000/1200	350

## ZN Series Dredge Pump Sectional Arrangement

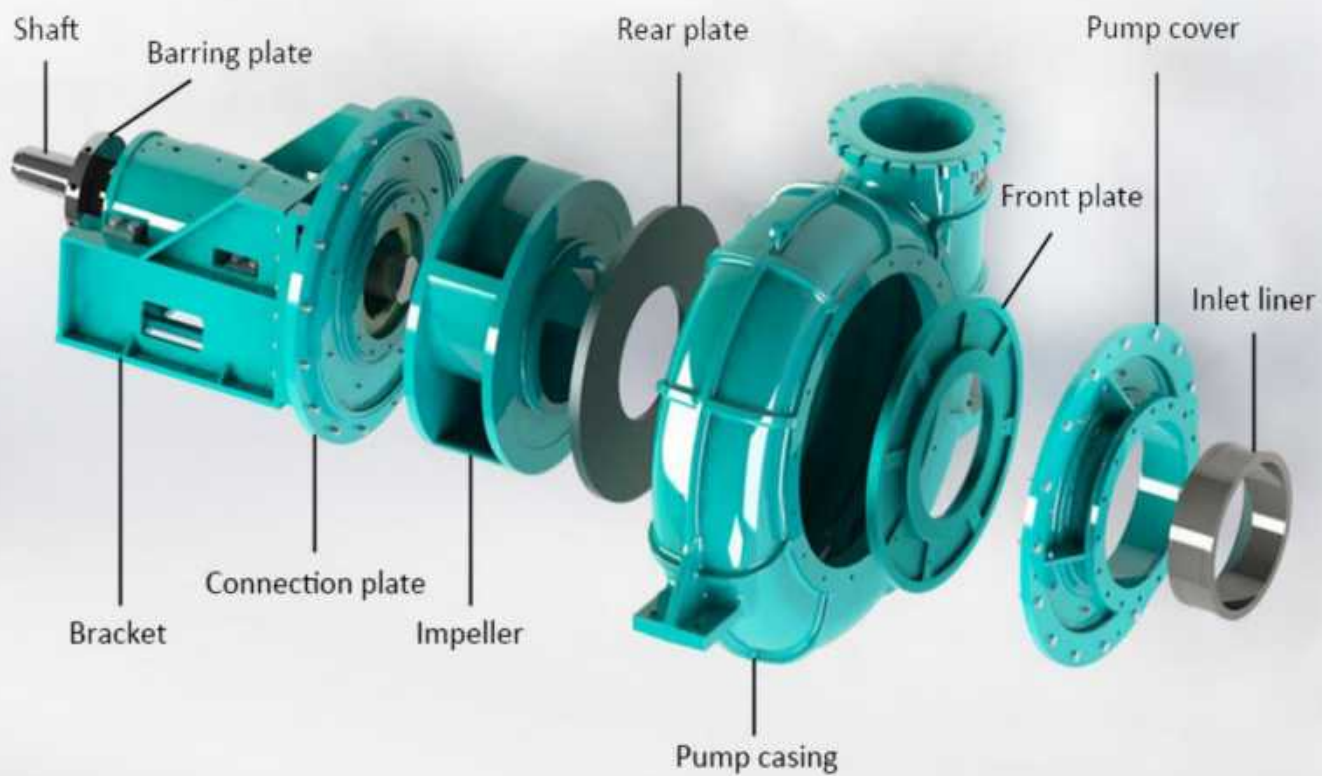
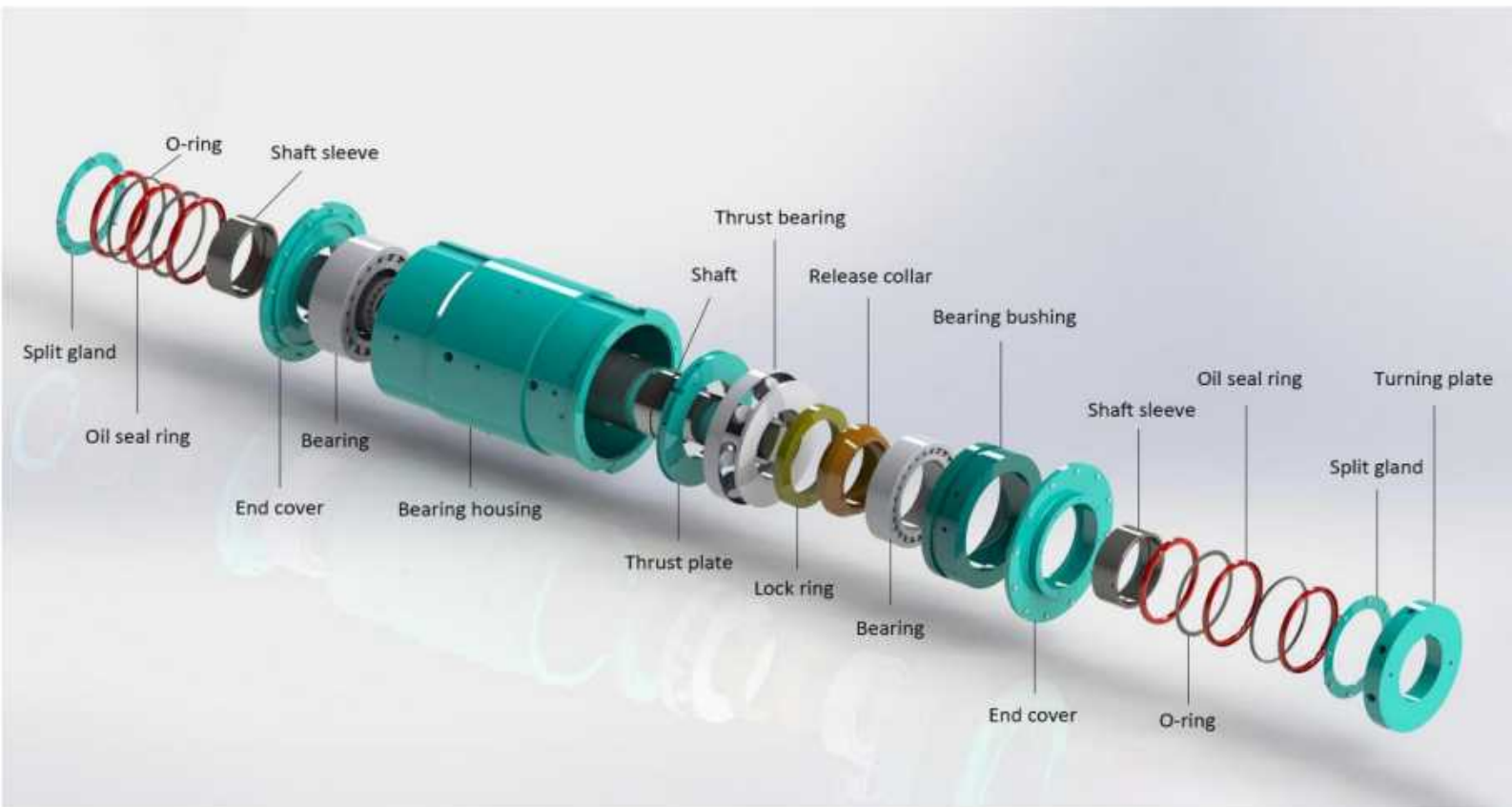



# ZJQ Submersible Sand Pump

The ZJQ submersible sludge sand pump is coaxial with the motor. When working, both the pump and the motor are submerged into the medium. The flow - parts of the pump are all made of high - chrome alloy, which have good performance in abrasion resistance. The big flow channel is used for transporting large solid particles, pulp, coal slurry, sandstone and other media that contain large solids. This series of pumps are designed and manufactured using domestic and foreign advanced technology. Besides the common impeller, the pump itself also has a set of agitation impeller. The agitation impeller can splash the deposition, then the pump can transport high - concentration medium without any other auxiliary devices.

Special sealing is used to balance the pressure inside and outside the oil box, which can protect the mechanical seal. The motor has overheat protection, waterproof protection, etc. All those can make the pump work under very severe conditions for a long time. This series of pumps can be used in the dredging project of rivers, streams, lakes, reservoirs, ports, etc. It is suitable to transport medium which contains solids, like construction sand, powder sand, silt, and this type of pump can also be used in steel factories, power plants, iron mining plants, oilfields to transport the sand of desilter ponds or sediment in sewage water treatment plants.



## PRODUCT APPLICATION:

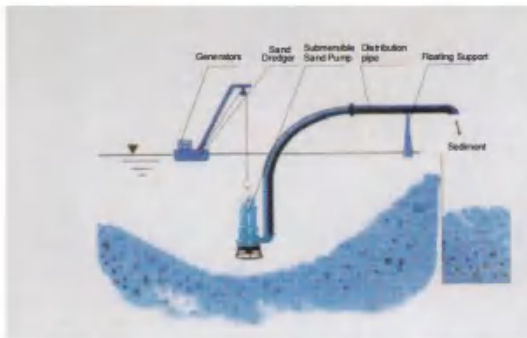

Sediment cleaning in rivers, lakes, seas, ponds and drinking water projects, as well as waterway dredging.

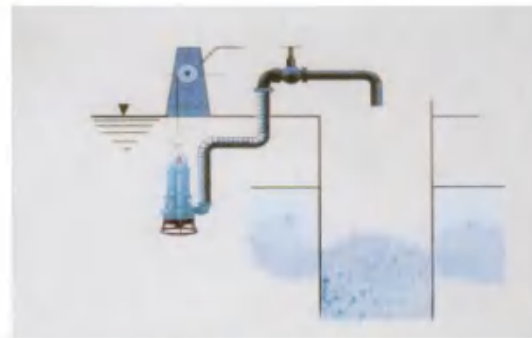

River sand pile engineering.

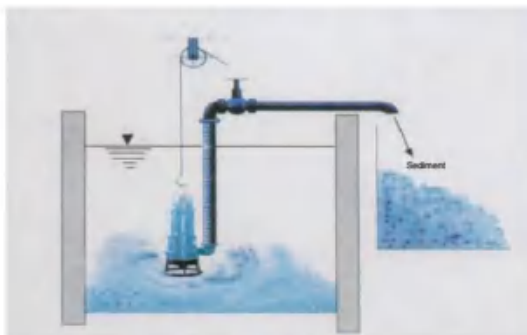

Blowdown and dredging of the deep well with large caliber.

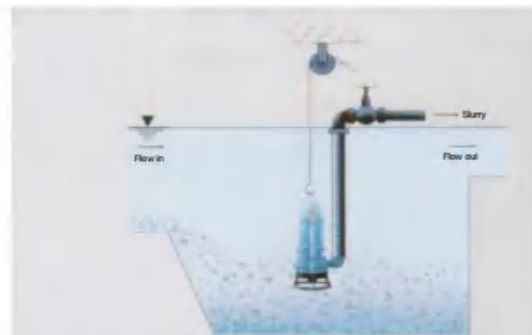

Sedimentation tanks are used in steel plants, power plants and various excavation engineering to eliminate slurry, sand and stone in water.

## PRODUCT INSTALLATION:

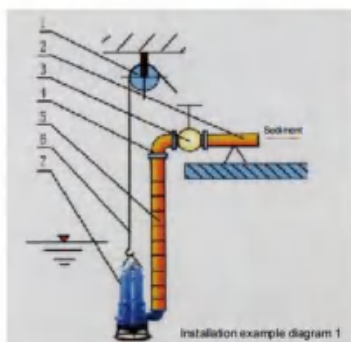

Installation Example Diagram No. 1

1. Hanging pump pulley
2. Transmission pipeline
3. Gate valve
4. Elbow pipe
5. Flexible pipe
6. Steel wire rope of the hanging pump
7. Submersible slurry pump

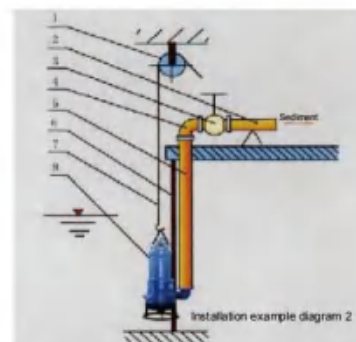

Installation Example Diagram No. 2

1. Hanging pump pulley
2. Transmission pipeline
3. Gate valve
4. Elbow pipe
5. Connecting steel pipe
6. Guide rail
7. Steel wire rope of the hanging pump
8. Submersible slurry pump



## ZJQ Series submersible sand pump specifications

MODEL	CAPACITY	HEAD	POWER	SPEED	Outlet Diameter	Max Particles Size
	m³/h	m	kw	r/min	mm	mm
ZJQ20-25-4	20	25	4	1460	50	6
ZJQ20-30-5.5	20	30	5.5	1460	50	7
ZJQ30-30-7.5	30	30	7.5	1460	80	13
ZJQ50-20-11	50	26	11	1460	80	21
ZJQ100-16-11	100	16	11	1460	100	21
ZJQ100-18-15	100	18	15	1460	100	21
ZJQ50-26-15	50	26	15	1460	80	21
ZJQ150-15-15	150	15	15	1460	100	21
ZJQ150-22-22	150	22	22	950	150	44
ZJQ200-15-22	200	15	22	950	150	44
ZJQ240-20-30	240	20	30	980	150	25
ZJQ100-35-30	100	35	30	980	100	25
ZJQ150-30-30	150	30	30	980	150	28
ZJQ300-20-37	300	20	37	980	200	28
ZJQ100-50-37	100	50	37	980	100	25
ZJQ200-30-45	200	30	45	980	150	25
ZJQ150-45-55	150	45	55	980	150	21
ZJQ250-35-55	250	35	55	980	150	35
ZJQ600-15-55	600	15	55	980	250	45
ZJQ350-35-75	350	35	75	980	200	28
ZJQ200-55-75	200	55	75	980	150	45
ZJQ450-30-90	450	30	90	980	200	28
ZJQ480-37-110	480	37	110	980	200	31
ZJQ1000-18-110	1000	18	110	980	300	45
ZJQ500-50-132	500	50	132	980	200	28
ZJQ1000-22-132	1000	22	132	980	300	45
ZJQ600-50-160	600	50	160	980	200	28
ZJQ1000-30-160	1000	30	30	980	300	53
ZJQ780-50-185	780	50	185	980	300	38
ZJQ600-55-200	600	55	200	980	250	42
ZJQ1500-20-200	1500	20	200	980	350	56
ZJQ800-55-220	800	55	220	980	300	38
ZJQ1250-35-220	1250	35	220	980	350	45
ZJQ1500-35-250	1500	35	250	980	350	50
ZJQ1750-30-250	1750	30	250	980	350	55

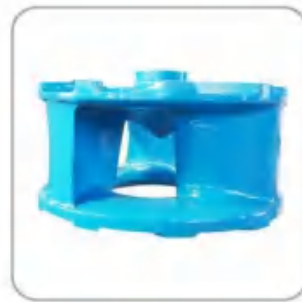
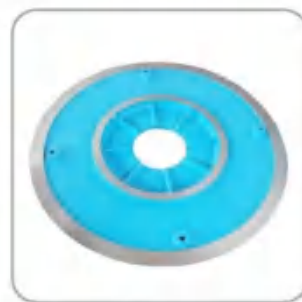
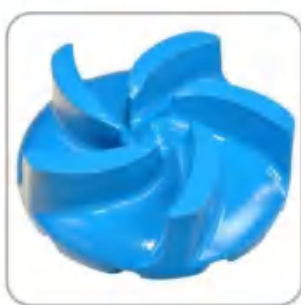





Tel: 0086-311-66792059

Fax: 0086-311-66792059

Web: [www.hbzdpump.com](http://www.hbzdpump.com)

E-mail: [admin@hbzdpump.com](mailto:admin@hbzdpump.com)

Add: Jinbohui Industrial Zone, Luancheng District, Shijiazhuang City, Hebei Province, China.

**HEBEI ZIDONG PUMP INDUSTRY CO.,LTD**



**紫东泵业**  
**ZIDONG PUMP**