

LFT2000 General Type Pressure Transmitter

FEATURES

- Adopt ceramic sensitive diaphragm with high overload capacity
- Excellent corrosion and wear resistance
- Using ASIC technology, digital compensation
- Small size, can be applied in various complex environment
- With a variety of threaded connection and electrical connections



DESCRIPTION

LFT2000 pressure transmitter is widely used in the measurement of fluid medium pressure in test systems such as fire protection, water treatment, water supply systems, air compressors, pneumatic devices, and factory automation. Adopt ceramic sensitive diaphragm with high overload capacity. It has excellent anti-corrosion and anti-wear performance, adopts ASIC technology, MEMS technology, and digital compensation. And it has the characteristics of small size and low price, can be applied in various complex environment.

SPECIFICATION

Measurement Range	-100kPa~0.3MPa...6MPa ,0~0.3MPa...60MPa			
Overload Pressure	1.5 times the rated pressure(up to 80Mpa)			
Burst Pressure	2 times the rated pressure(up to 90Mpa)			
Accuracy	±0.5%F.S、 ±1.0%F.S			
Stability	<0.5%F. S/year			
Working Temp	-20~85°C			
Storage Temp	-40~100°C			
Measured Medium	Gas or liquid compatible with 1Cr18Ni9Ti, 304 stainless steel, Fluorine rubber or Nitrile rubber			
Electrical Properties	2-wired	3-wired		
Output Signal	4~20mA	0.5~4.5V	0~5V	0~10V
Power Supply	10~36VDC	4.75~5.25VDC	10~36VDC	12~36VDC
Electrical Connections	Packard, DIN43650C (small Hirschmann), DIN43650A (big Hirschmann), M12 waterproof outlet, M12 aviation connector, GX12 aviation connector (three-core/four-core)			
Enclosure Protection	IP67、 IP65、 IP54			
Pressure Connection	G1/4、 NPT1/4、 R1/4、 BPS1/4、 G1/2、 7/16-20UNF、 M20*1.5、 M10*1、 M14*1.5 etc			
Pressure Form	Gauge Pressure G			
Certification	Safety explosion-proof type E, RoHS, EU electrical safety standard CE			

DIMENSION (mm)

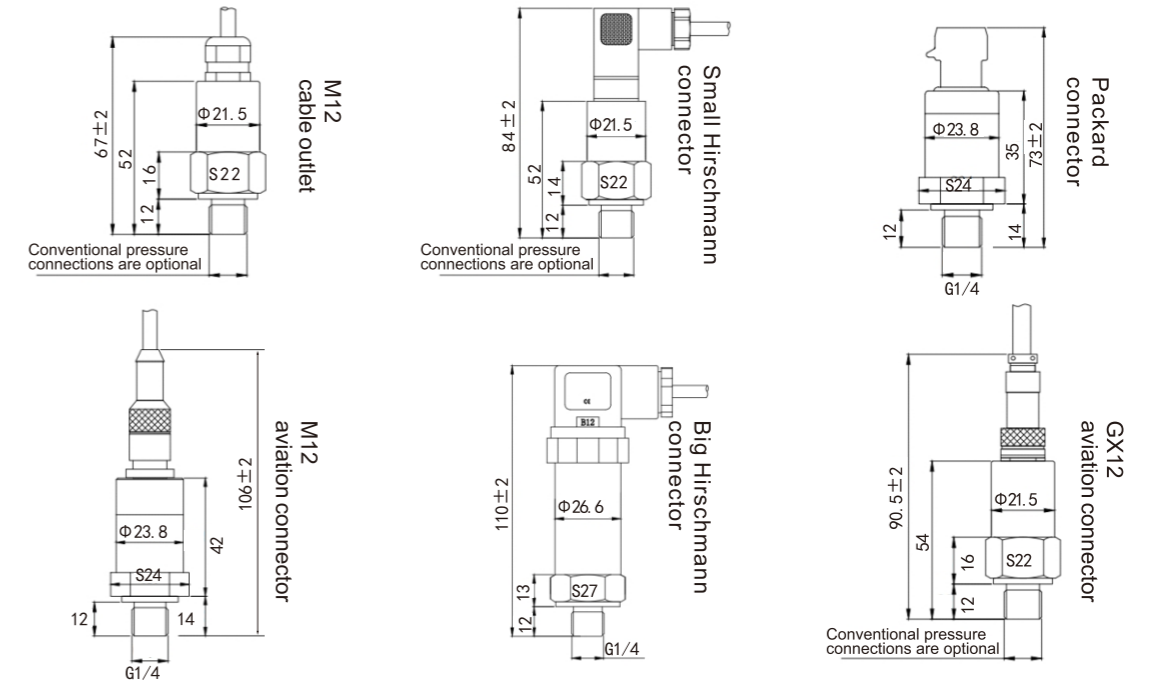

ORDER REF NO.

Code and description		Remark						
LFT2000		Model						
Range	-100kPa~0.3MPa...6MPa , 0~0.3MPa...60MPa	Measurement Range						
A4	A4 = 4~20mA(2-wired)	Output Mode						
V05	V05 = 0.5~4.5V(3-wired)							
VO	V0 = 0~5V(3-wired)							
V10	V10 = 0~10V(3-wired)							
K	K = kPa	Measurement Unit						
P	P = psi							
B	B = Bar	M	M = MPa					
0.5	0.5 = 0.5%F.S	Accuracy						
1.0	1.0 = 1.0%F.S							
P	P = Packard(Packard)	Electrical Connection						
D	D = DIN43650C(Small Hirschmann)							
D1	D1 = DIN43650A(Big Hirschmann)							
M	M = M12 (M12waterproof outlet)							
C3	C3=GX12 Three core aviation connector							
C4	C4=GX12 Four core aviation connector							
H	H=M12 Four core aviation connector	Pressure Connection						
G	G = G1/4		G2	G2 = G1/2				
N	N = NPT1/4		M20	M20 = M20*1.5				
R	R = R1/4		U	U = 7/16-20 UNF External thread				
B	B = BSP1/4							
1.0	1.0 = 1m	Cable Length						
2.0	2.0 = 2m							
3.0	3.0 = 3m							
LFT2000	0-16	A4	B	1.0	P	G	1.0	Selection Example